

Corporate Meetings

*Anything We Can Do To Make Your Day Unique
And Memorable Is Our Pleasure!*



- ◆ *Personalized Service*
- ◆ *Air Conditioned Facility*
- ◆ *Rooms Can Be Arranged in Many Styles*
- ◆ *Wireless Internet Access*
- ◆ *Quiet Retreat Setting*



Thank You For Considering Pats Peak Banquet Center

Enclosed you will find helpful information on planning your meeting or workshop at Pats Peak along with our menu selections. Please remember, you are not limited to the menu selections listed. We will "cater" to your every whim! Pats Peak regularly accommodates menu requests of all types. If you have special religious or dietary needs or simply prefer another selection, Pats Peak's Banquet Staff is happy to serve you.

Choose from two air-conditioned rooms. Our rooms can be arranged in many styles with podium and microphone capabilities. Audio-visual equipment is available, please be sure to let us know your AV needs in advance. Wireless Internet Access is available in both lodges. Large wooden decks face the mountain offering spectacular views and a tranquil setting.

If you haven't done so already, please contact me to make arrangements to view our Banquet Center in person. Remember, "Personalized Service" is what makes Pats Peak a favorite meeting location. Anything our staff can do to make your day unique and memorable is our pleasure!

Sincerely,



Jessica Gilbert
Pats Peak Banquet Center
1-888-PATS PEAK ext. 123
(603) 428-3245, ext. 123



Meeting Guide Breakfast Selections

Prices are per person.

Continental Breakfast

\$5.95 per person

Muffins

Danishes

Bagels

Selection of Cream Cheeses and Jellies

Assorted Juices

Coffee

Tea

Breakfast Buffet

\$9.95 per person

Scrambled Eggs

French Toast

Bacon

Sausage

Home Fries

Muffins

Danishes

Assorted Juices

Coffee

Tea

18% gratuity and 9% rooms and meals tax additional on all food, beverages and room rental.

Prices subject to change.

We regret that banquet food can not be removed from the premises.

Breakfast Selections are not available for Wedding Receptions.

Pats Peak Banquet Center • Henniker, NH • (603) 428-3245 • patspeak.com



Banquet Full-Service Buffet Lunch Entree Selections

Prices are per person and include a choice of salad and dinner rolls.

If selecting (2) Lunch Entree Selections, add an additional \$4.00 per person to the higher priced lunch entree selection.

Sautéed Steak Tips with Red Wine Sauce <i>Served with Caramelized Onions, Rice Pilaf and Seasonal Vegetables.</i>	\$14.95
Grilled Salmon with Herb Butter <i>Served with Rice Pilaf and Seasonal Vegetables.</i>	\$14.95
Baked Haddock <i>Seasoned Bread Crumbs with an Herb Cream Sauce. Served with Rice Pilaf and Seasonal Vegetables.</i>	\$14.95
Lasagna <i>Select One ~ Vegetarian or Meat.</i>	\$12.95
Grilled Herbed Boneless Chicken Breast <i>Served with Rice Pilaf and Seasonal Vegetables.</i>	\$12.95
Chicken Parmesan <i>Served with Pasta and Marinara Sauce.</i>	\$12.95
Chicken & Broccoli Alfredo <i>Served with Pasta.</i>	\$12.95
Chicken Quesadilla <i>Served with Salsa, Sour Cream & Guacamole.</i>	\$10.95
Pasta Bar <i>Served with (2) selections of sauces, grilled chicken, grilled vegetables and parmesan cheese.</i>	\$10.95
Teriyaki Chicken <i>Served with rice.</i>	\$10.95
Homemade Chili <i>Served in a taco bowl with sour cream & scallions.</i>	\$9.95
8 oz. Angus Burger <i>Served with french fries.</i>	\$9.75
Soup & Salad <i>Choice of Soup and Salad.</i>	\$9.50

18% gratuity and 9% rooms and meals tax additional on all food, beverages and room rental.
Prices subject to change. We regret that banquet food cannot be removed from the premises.

We serve only Certified Angus Beef® selections.

Lunch Selections are not available for Wedding Receptions.

Pats Peak Banquet Center • Henniker, NH • (603) 428-3245 • patspeak.com



Selections to Accompany Buffet Lunch Entree

Potato / Rice

Select One

Red Roasted Potato with Garlic and Herbs
Sautéed New Potato with Fresh Dill and Onions
Baked Potato with Sour Cream and Chives
Mashed Potato
Garlic Mashed Potato
Rice Pilaf

Vegetable

Select One

Mélange - Carrots, Broccoli, Cauliflower
Glazed Carrots
Green Beans Almondine with Onion and Red Pepper
Baked Squash with Maple Syrup Sauce
Broccoli Stir Fry
Summer Squash Medley

Salad

Select One

Caesar Salad
Garden Salad
Spinach Salad
Wild Greens Salad

Pasta Sides

Add additional \$4.00 per side, per person to the entree selection price.

Tortellini Alfredo
Penne with Sausage & Peppers
Stuffed Manicotti
Pasta Primavera ~ Pesto Sauce and Vegetables
Roma ~ Roasted Garlic Cream with Red Pepper and Fresh Basil
Vegetable Lasagna
Meat Lasagna
Ravioli



Meeting Guide

Lunch Platter Selections

Prices are per person. All Sandwich Platters are served with Chips and Pickles.
Add \$1.00 per person for French Fries.

(These Lunch Platter Selections are only available for lunchtime meetings.)

Over-Stuffed Finger Sandwich Platter

\$7.95 per person

Tuna Salad

Chicken Salad

Egg Salad

Ham Salad

Assorted Wrap Platter

Select Three

\$9.95 per person

Southwestern Chicken

Seasoned Chicken, Sautéed Peppers & Onions, with Tangy Southwestern Ranch Sauce.

Roast Beef

Served with Horseradish Mustard Sauce.

Roast Turkey

Served with Lettuce, Tomato and Mayonnaise.

Smoked Ham & Swiss

Served with Honey Mustard Sauce.

Hummus, Sprouts & Red Onion

Served with Roasted Red Pepper & Spinach.

Grilled Chicken Caesar

Grilled Chicken with Classic Caesar Salad.

Italian

Salami, Ham, Tomato, Provolone Cheese & Pesto.

Gourmet Sandwich Platter

Your choice of Baguette, Croissant, Kaiser Roll or Focaccia.

Select Three

\$10.95 per person

Smoked Turkey, Smoked Bacon, Cheddar Cheese

Prosciutto, Salami, Provolone, Roasted Red Pepper, Tomato, Onion Aioli & Pesto Dressing

Grilled Chicken Roma, Sundried Tomatoes, Imported Olives, Roasted Shallot Herb Spread

Grilled Portabella Mushrooms, Zucchini, Eggplant, Roasted Garlic, Fresh Mozzarella

Seafood Salad with Herb Mayonnaise & Lettuce

French Dip with Thinly Sliced Roast Beef Au Jus

18% gratuity and 9% rooms and meals tax additional on all food, beverages and room rental.

Prices subject to change.

We regret that banquet food can not be removed from the premises.

Lunch Platter Selections are not available for Wedding Receptions

Pats Peak Banquet Center • Henniker, NH • (603) 428-3245 • patspeak.com



Meeting Guide

Lunch Soup Selections

*\$5.00 per person,
per Soup Selection.*

New England Clam Chowder

Seafood Chowder

Grilled Chicken & Corn Chowder

Cream of Broccoli

Garden Vegetable

Tomato Tortellini

Lunch Salad Selections

*\$4.50 per person,
per Salad Selection.*

Potato & Egg Salad

Mixed Baby Green Salad

Caesar Salad

Coleslaw or Broccoli Slaw

Pepper Pasta Salad

Summer Salad ~ Fresh Mozzarella, Tomato, Balsamic Vinaigrette, Over Lettuce

Spinach Salad ~ Mushroom, Egg, Tomato, Bacon, Red Onion and Red Pepper

18% gratuity and 9% rooms and meals tax additional on all food, beverages and room rental.

Prices subject to change.

We regret that banquet food can not be removed from the premises.

Lunch Selections are only available for lunchtime meetings and not available for Wedding Receptions.

Pats Peak Banquet Center • Henniker, NH • (603) 428-3245 • patspeak.com



Meeting Guide

Lunch Entree Salad Creations

(These Lunch Entree Salad Creations are only available for lunchtime meetings.)

Create Your Own Salad!

\$10.95 per person

Ingredients are served buffet style for each guest to "create their own."

Served with rolls & salad dressing.

Caesar

Fresh Chopped Romaine Lettuce

Parmesan Cheese

Croutons

Grilled Chicken

Grilled Steak Tips

Grilled Eggplant, Summer Squash, Zucchini, Roasted Red Pepper,

Portabella Mushrooms, Black Olives & Anchovies

All American

Fresh Wild Greens Salad

Turkey

Ham

Cheddar Cheese

Crumbled Bacon

Hard Boiled Egg

Croutons

Cucumber, Tomato, Mushroom, Onion, Pepper & Avocado

Oriental

Oriental Salad Blend of Green Leaf Lettuce and Bok Choy

Sauteed Shrimp

Sauteed Teriyaki Chicken

Scallions, Water Chestnuts, Bean Sprouts, Chow Mein Noodles, Almonds,

Snow peas, Mandarin Orange Slices & Red Peppers

*18% gratuity and 9% rooms and meals tax additional on all food, beverages and room rental.
Prices subject to change. We regret that banquet food cannot be removed from the premises.*

We serve only Certified Angus Beef® selections.

Lunch Entree Salad Creations are not available for Wedding Receptions.

Pats Peak Banquet Center • Henniker, NH • (603) 428-3245 • patspeak.com



Meeting Guide Hors d'oeuvres Selections

Prices are per person.

Garden Crudite <i>Fresh Raw Vegetable Display with Seasoned Dips.</i>	\$3.00
Gourmet Fromage Display <i>Muenster, Cheddar, Swiss, Pepper Jack, Garlic Herb Spread, Smoked Gouda, Dill Havarti, Pepperoni, Salami, Fresh Fruit including Grapes, Strawberries & Melon with Assorted Crackers.</i>	\$4.00
Flat Bread Alfredo Pizza <i>Alfredo Sauce, Fresh Tomato & Fresh Basil.</i>	\$3.00
Meatballs <i>Select One ~ Italian, Swedish, BBQ, Sweet and Sour</i> <i>Select Two ~ Italian, Swedish, BBQ, Sweet and Sour</i>	\$3.00 \$3.25
Stuffed Mushroom Caps <i>Select One ~ Crab Almond, Spinach Feta, Mild Italian, Spicy Cajun</i> <i>Select Two ~ Crab Almond, Spinach Feta, Mild Italian, Spicy Cajun</i>	\$3.00 \$3.25
Baked Brie <i>Select One ~ Raspberry Almond En Croute, Hazelnut Crusted served with fresh pears</i>	\$4.00
Mediterranean Display <i>Warm Artichoke and Spinach Dip, Hummus and Spanakopita accompanied by crackers and bread.</i>	\$4.00
Chicken Satay <i>Marinated Chicken Grilled and Served with a peanut sauce.</i>	\$4.00
Mini Crab Cakes <i>Homemade mini Crab Cakes served with a horseradish mayonaise sauce.</i>	\$4.50
Teriyaki Steak Skewers <i>Marinated Steak Skewers served with a teriyaki dipping sauce.</i>	\$4.50
Shrimp Cocktail <i>Large Shrimp served cool and crisp with cocktail sauce.</i>	\$5.00
Scallops Wrapped in Bacon <i>Fresh Scallops wrapped in bacon and baked. Brushed with a maple syrup glaze.</i>	\$5.00

**Most Hors d'oeuvres can be passed upon request.*

*18% gratuity and 9% rooms and meals tax additional on all food, beverages and room rental.
Prices subject to change. We regret that banquet food cannot be removed from the premises.*

We serve only Certified Angus Beef® selections.



PATS PEAK

Pats Peak Banquet Center • Henniker, NH • (603) 428-3245 • patspeak.com

Dessert Selections

*Prices are per person,
per Dessert Selection.*

<i>Chocolate Dipped Strawberries</i>	<i>\$4.00</i>
<i>Vanilla Cream Puffs Laced with Chocolate</i>	<i>\$4.00</i>
<i>Fruit Filled Crepes</i>	<i>\$4.00</i>
<i>Almond Joy Tart</i>	<i>\$4.00</i>
<i>Brownie Sundae</i>	<i>\$4.00</i>
<i>Assorted Cheesecake</i>	<i>\$4.00</i>
<i>Tiramisu</i>	<i>\$3.75</i>
<i>Strawberry Shortcake</i>	<i>\$3.50</i>
<i>Brownie</i>	<i>\$3.50</i>
<i>Carrot Cake</i>	<i>\$3.50</i>
<i>Fresh Fruit Platter</i>	<i>\$3.50</i>
<i>Assorted Cookie Tray</i>	<i>\$3.00</i>
<i>Apple Crisp</i>	<i>\$3.00</i>
<i>Apple Pie</i>	<i>\$3.00</i>

Chocolate Fountains available - Please inquire if interested.

18% gratuity and 9% rooms and meals tax additional on all food, beverages and room rental.

Prices subject to change.

We regret that banquet food can not be removed from the premises.



Pats Peak Banquet Center • Henniker, NH • (603) 428-3245 • patspeak.com

Beverage Selections

We serve a full range of spirits, wines and beer.

*You may arrange for a full open bar, limited open bar, or a cash bar,
whatever meets your needs.*

Liquor Prices

<i>Domestic & Imported Draft Beer</i>	<i>\$4.25 to \$7.25</i>
<i>Bottle Beer (Valley Room Only)</i>	<i>\$4.75 to \$6.25</i>
<i>House Wine</i>	<i>\$5.00</i>
<i>Soda</i>	<i>\$1.75</i>
<i>Juice</i>	<i>\$1.75</i>
<i>Mixed Drinks</i>	<i>\$5.00 to \$7.00</i>

Champagne Toasts

<i>Domestic Champagne</i>	<i>\$3.00 per person</i>
<i>Non-Alcoholic Sparkling Cider or Grape</i>	<i>\$3.00 per person</i>
<i>Imported Champagne</i>	<i>\$4.00 per person</i>

Punch Bowls

<i>Spirited Bowl (serves 30)</i>	<i>\$85.00</i>
<i>Non-Spirited Bowl (serves 30)</i>	<i>\$50.00</i>

18% gratuity and 9% rooms and meals tax additional on all food, beverages and room rental.

Prices subject to change.

Beverage Policy ~ Pats Peak's managers, bartenders and servers are trained in responsible beverage service and if necessary will deny service to anyone that, in their opinion, appears to have consumed more alcohol than is considered safe and responsible. Under no circumstances will anyone under 21 years old be served. In accordance with NH State Law, no alcohol is allowed to be brought onto or leave the premises by guests.



Midweek Corporate Meetings/Workshops

For midweek corporate meetings/workshops, the Rental Fee is based on an (8) eight-hour time period.
Fees Subject To Change.

Rental Fee includes Linens, Set-Up, Clean-Up, Coffee and Tea Station,
Full China Setting including Water Goblet, Luncheon Plate, Salad Plate & Silverware.

<u>Room</u>	<u>Rental Fee with Food Purchase</u>	<u>Rental Fee with No Food Purchase</u>
Sleigh Room (includes Sled Pub)	\$200	\$500
Valley Room	\$200	\$500

*Greater Concord Chamber of Commerce Members and Henniker Chamber of Commerce Members receive a discounted rate, please inquire if you are a member.

Audio Visual Equipment

Limited Audio Visual available onsite.

Please let us know what you need for your event and we will do our best to provide it for you.

Some items may require an additional rental fee.

Screen

Podium

Microphone

Television

DVD

VCR

Terms and Conditions

Subject To Change

- A \$500 Non-Refundable/Non-Transferable Deposit and Signed Contract will secure the date of your choice.
- We require 50% payment of your Estimated Bill (1) One Month prior to your event. Cancellation within 30 days or less of scheduled event will result in forfeiture of 50% of total balance of estimated invoice.
- The Final Menu Selections, Confirmed Numbers and Final Balance due (2) Two Weeks prior to your event. Cancellation within 14 days or less of scheduled event will result in forfeiture of 100% of total balance of final invoice.
- MasterCard, Visa and American Express credit cards are welcomed.
- 18% gratuity and 9% rooms and meals tax additional on all food, beverages, and room rental.



Directions To Pats Peak Banquet Center

686 Flanders Road, Henniker, NH 03242

“The Only Henniker On Earth”

Conveniently located in Southern NH off I-89

From Manchester, NH

40 Minutes

Take I-93 North to Concord, NH. Take I-89 North. Take Exit 5 (a left hand exit). Follow Route 202/9 West. Take the Henniker Exit (Route 114). Follow Route 114 South. Go straight through the center of town for approximately 2 miles and look for the Pats Peak sign on your right. Take the right and follow the road to the Pats Peak entrance.

From Boston, MA

1 1/2 Hours

Take I-93 North to Concord, NH. Take I-89 North. Take Exit 5 (a left hand exit). Follow Route 202/9 West. Take the Henniker Exit (Route 114). Follow Route 114 South. Go straight through the center of town for approximately 2 miles and look for the Pats Peak sign on your right. Take the right and follow the road to the Pats Peak entrance.

From Burlington, VT

2 Hours

Take I-89 South to Exit 5 (Route 202/9 West). Proceed on Route 202/9 West to the Henniker Exit (Route 114). Follow Route 114 South. Go straight through the center of town for approximately 2 miles and look for Pats Peak on your right. Take the right and follow the road to the Pats Peak entrance.

From Brattleboro, VT

1 1/4 Hours

Take Route 9 East to Henniker. Take the Henniker Exit (Route 114). Follow Route 114 South. Go straight through the center of town for approximately 2 miles and look for the Pats Peak sign on your right. Take the right and follow the road to the Pats Peak entrance.

From Portsmouth, NH

1 1/4 Hours

Take Route 4 West to Concord, NH. Merge onto I-393 West/US-202 West/US-4 West toward I-93. Take I-93 South toward I-89. Take I-89 North. Take Exit 5 (a left hand exit). Follow Route 202/9 West. Take the Henniker Exit (Route 114). Follow Route 114 South. Go straight through the center of town for approximately 2 miles and look for the Pats Peak sign on your right. Take the right and follow the road to the Pats Peak entrance.



Pats Peak Banquet Center Floor Plans

Pats Peak Base Area

Main Lodge and Valley Lodge

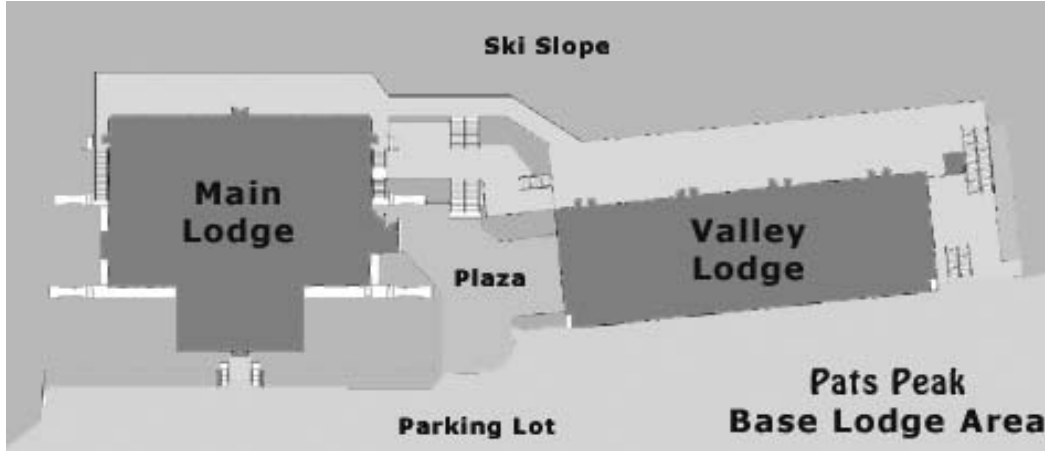

The Valley Room

Located in the Valley Lodge

*Air Conditioning, Beautiful Large Windows,
Space for Dining and Dancing, Cocktail Area, Large Slope Side Deck*

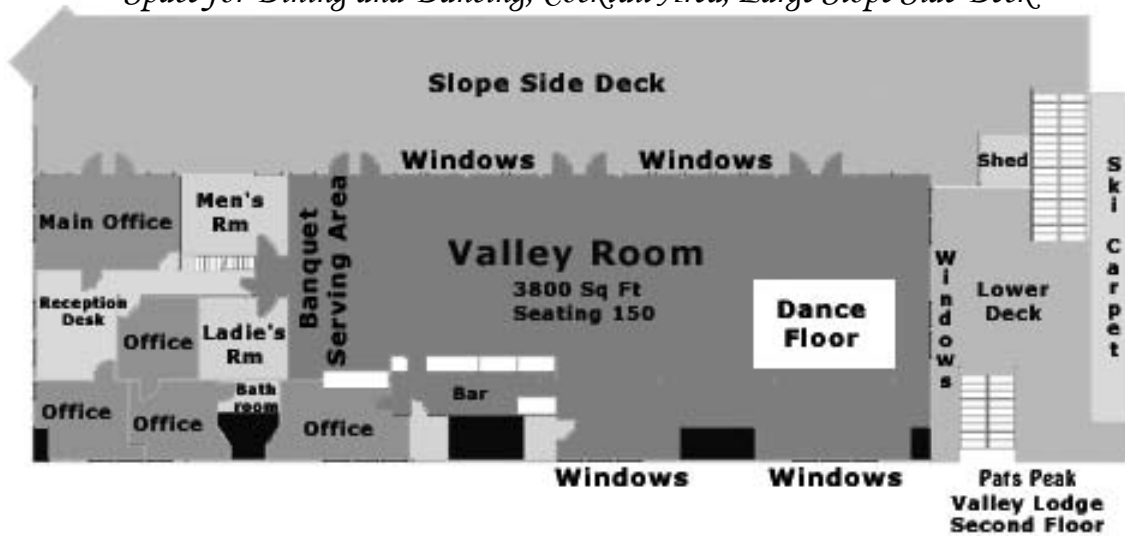

Pats Peak Banquet Center Floor Plans

Sleigh Room and Sled Pub

Located on the Third Floor of the Main Lodge

Air Conditioning, Beautiful Stone Fireplace, Space for Dining and Dancing,
Adjacent Sled Pub Lounge Area, Large Sun Deck

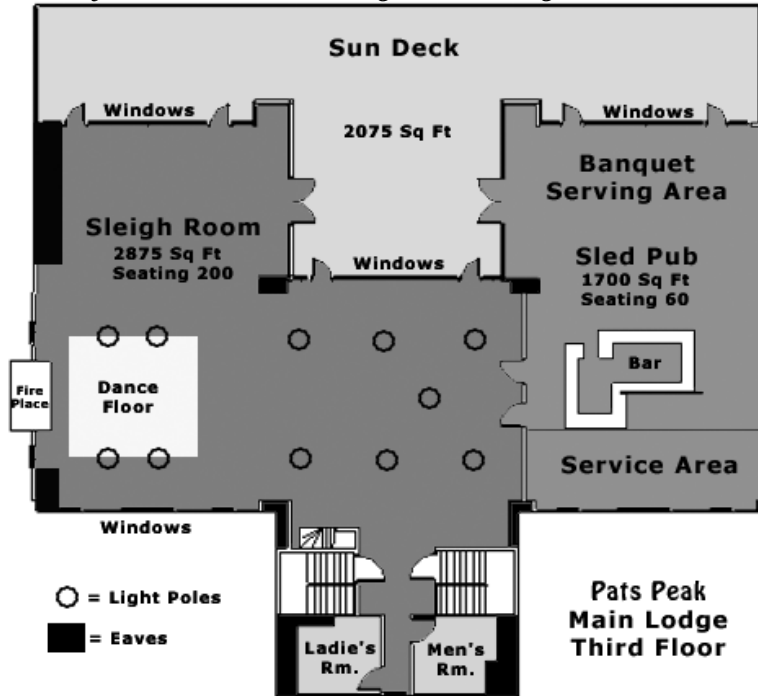

Oak Room

Located on the Second Floor of the Main Lodge

Beautiful Stone Fireplace, Indoor Wedding Ceremony Location

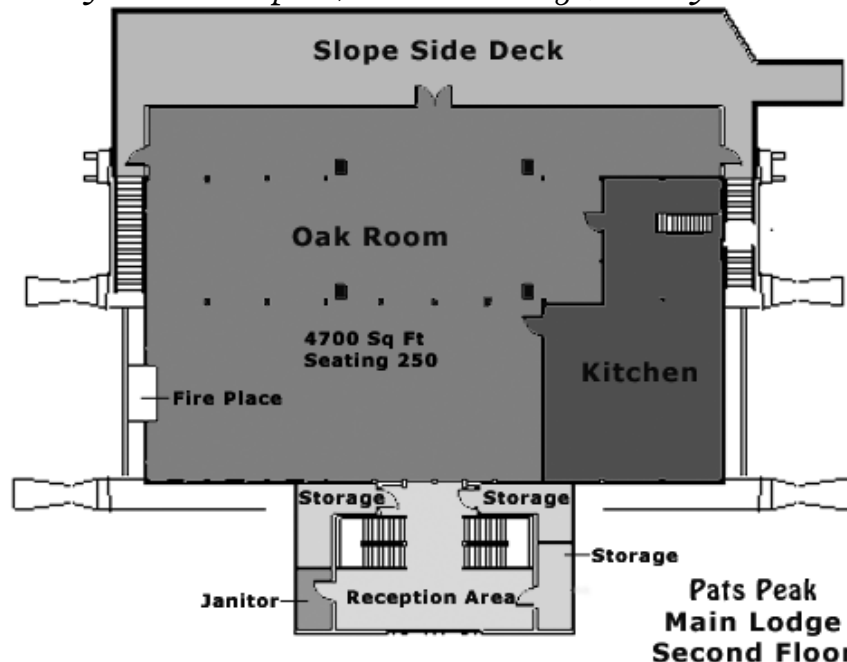

Corporate Meetings

*Anything We Can Do To Make Your Day Unique
And Memorable Is Our Pleasure!*



- ◆ *Personalized Service*
- ◆ *Air Conditioned Facility*
- ◆ *Rooms Can Be Arranged in Many Styles*
- ◆ *Wireless Internet Access*
- ◆ *Quiet Retreat Setting*



Thank You For Considering Pats Peak Banquet Center

Enclosed you will find helpful information on planning your meeting or workshop at Pats Peak along with our menu selections. Please remember, you are not limited to the menu selections listed. We will "cater" to your every whim! Pats Peak regularly accommodates menu requests of all types. If you have special religious or dietary needs or simply prefer another selection, Pats Peak's Banquet Staff is happy to serve you.

Choose from two air-conditioned rooms. Our rooms can be arranged in many styles with podium and microphone capabilities. Audio-visual equipment is available, please be sure to let us know your AV needs in advance. Wireless Internet Access is available in both lodges. Large wooden decks face the mountain offering spectacular views and a tranquil setting.

If you haven't done so already, please contact me to make arrangements to view our Banquet Center in person. Remember, "Personalized Service" is what makes Pats Peak a favorite meeting location. Anything our staff can do to make your day unique and memorable is our pleasure!

Sincerely,



Jessica Gilbert
Pats Peak Banquet Center
1-888-PATS PEAK ext. 123
(603) 428-3245, ext. 123



Meeting Guide Breakfast Selections

Prices are per person.

Continental Breakfast

\$5.95 per person

Muffins

Danishes

Bagels

Selection of Cream Cheeses and Jellies

Assorted Juices

Coffee

Tea

Breakfast Buffet

\$9.95 per person

Scrambled Eggs

French Toast

Bacon

Sausage

Home Fries

Muffins

Danishes

Assorted Juices

Coffee

Tea

18% gratuity and 9% rooms and meals tax additional on all food, beverages and room rental.

Prices subject to change.

We regret that banquet food can not be removed from the premises.

Breakfast Selections are not available for Wedding Receptions.

Pats Peak Banquet Center • Henniker, NH • (603) 428-3245 • patspeak.com



Banquet Full-Service Buffet Lunch Entree Selections

Prices are per person and include a choice of salad and dinner rolls.

If selecting (2) Lunch Entree Selections, add an additional \$4.00 per person to the higher priced lunch entree selection.

Sautéed Steak Tips with Red Wine Sauce <i>Served with Caramelized Onions, Rice Pilaf and Seasonal Vegetables.</i>	\$14.95
Grilled Salmon with Herb Butter <i>Served with Rice Pilaf and Seasonal Vegetables.</i>	\$14.95
Baked Haddock <i>Seasoned Bread Crumbs with an Herb Cream Sauce. Served with Rice Pilaf and Seasonal Vegetables.</i>	\$14.95
Lasagna <i>Select One ~ Vegetarian or Meat.</i>	\$12.95
Grilled Herbed Boneless Chicken Breast <i>Served with Rice Pilaf and Seasonal Vegetables.</i>	\$12.95
Chicken Parmesan <i>Served with Pasta and Marinara Sauce.</i>	\$12.95
Chicken & Broccoli Alfredo <i>Served with Pasta.</i>	\$12.95
Chicken Quesadilla <i>Served with Salsa, Sour Cream & Guacamole.</i>	\$10.95
Pasta Bar <i>Served with (2) selections of sauces, grilled chicken, grilled vegetables and parmesan cheese.</i>	\$10.95
Teriyaki Chicken <i>Served with rice.</i>	\$10.95
Homemade Chili <i>Served in a taco bowl with sour cream & scallions.</i>	\$9.95
8 oz. Angus Burger <i>Served with french fries.</i>	\$9.75
Soup & Salad <i>Choice of Soup and Salad.</i>	\$9.50

18% gratuity and 9% rooms and meals tax additional on all food, beverages and room rental.
Prices subject to change. We regret that banquet food cannot be removed from the premises.

We serve only Certified Angus Beef® selections.

Lunch Selections are not available for Wedding Receptions.

Pats Peak Banquet Center • Henniker, NH • (603) 428-3245 • patspeak.com



Selections to Accompany Buffet Lunch Entree

Potato / Rice

Select One

Red Roasted Potato with Garlic and Herbs
Sautéed New Potato with Fresh Dill and Onions
Baked Potato with Sour Cream and Chives
Mashed Potato
Garlic Mashed Potato
Rice Pilaf

Vegetable

Select One

Mélange - Carrots, Broccoli, Cauliflower
Glazed Carrots
Green Beans Almondine with Onion and Red Pepper
Baked Squash with Maple Syrup Sauce
Broccoli Stir Fry
Summer Squash Medley

Salad

Select One

Caesar Salad
Garden Salad
Spinach Salad
Wild Greens Salad

Pasta Sides

Add additional \$4.00 per side, per person to the entree selection price.

Tortellini Alfredo
Penne with Sausage & Peppers
Stuffed Manicotti
Pasta Primavera ~ Pesto Sauce and Vegetables
Roma ~ Roasted Garlic Cream with Red Pepper and Fresh Basil
Vegetable Lasagna
Meat Lasagna
Ravioli



PATS PEAK

Pats Peak Banquet Center • Henniker, NH • (603) 428-3245 • patspeak.com

Meeting Guide Lunch Platter Selections

Prices are per person. All Sandwich Platters are served with Chips and Pickles.
Add \$1.00 per person for French Fries.

(These Lunch Platter Selections are only available for lunchtime meetings.)

Over-Stuffed Finger Sandwich Platter

\$7.95 per person

Tuna Salad

Chicken Salad

Egg Salad

Ham Salad

Assorted Wrap Platter

Select Three

\$9.95 per person

Southwestern Chicken

Seasoned Chicken, Sautéed Peppers & Onions, with Tangy Southwestern Ranch Sauce.

Roast Beef

Served with Horseradish Mustard Sauce.

Roast Turkey

Served with Lettuce, Tomato and Mayonnaise.

Smoked Ham & Swiss

Served with Honey Mustard Sauce.

Hummus, Sprouts & Red Onion

Served with Roasted Red Pepper & Spinach.

Grilled Chicken Caesar

Grilled Chicken with Classic Caesar Salad.

Italian

Salami, Ham, Tomato, Provolone Cheese & Pesto.

Gourmet Sandwich Platter

Your choice of Baguette, Croissant, Kaiser Roll or Focaccia.

Select Three

\$10.95 per person

Smoked Turkey, Smoked Bacon, Cheddar Cheese

Prosciutto, Salami, Provolone, Roasted Red Pepper, Tomato, Onion Aioli & Pesto Dressing

Grilled Chicken Roma, Sundried Tomatoes, Imported Olives, Roasted Shallot Herb Spread

Grilled Portabella Mushrooms, Zucchini, Eggplant, Roasted Garlic, Fresh Mozzarella

Seafood Salad with Herb Mayonnaise & Lettuce

French Dip with Thinly Sliced Roast Beef Au Jus

18% gratuity and 9% rooms and meals tax additional on all food, beverages and room rental.

Prices subject to change.

We regret that banquet food can not be removed from the premises.

Lunch Platter Selections are not available for Wedding Receptions

Pats Peak Banquet Center • Henniker, NH • (603) 428-3245 • patspeak.com



Meeting Guide

Lunch Soup Selections

*\$5.00 per person,
per Soup Selection.*

New England Clam Chowder

Seafood Chowder

Grilled Chicken & Corn Chowder

Cream of Broccoli

Garden Vegetable

Tomato Tortellini

Lunch Salad Selections

*\$4.50 per person,
per Salad Selection.*

Potato & Egg Salad

Mixed Baby Green Salad

Caesar Salad

Coleslaw or Broccoli Slaw

Pepper Pasta Salad

Summer Salad ~ Fresh Mozzarella, Tomato, Balsamic Vinaigrette, Over Lettuce

Spinach Salad ~ Mushroom, Egg, Tomato, Bacon, Red Onion and Red Pepper

18% gratuity and 9% rooms and meals tax additional on all food, beverages and room rental.

Prices subject to change.

We regret that banquet food can not be removed from the premises.

Lunch Selections are only available for lunchtime meetings and not available for Wedding Receptions.

Pats Peak Banquet Center • Henniker, NH • (603) 428-3245 • patspeak.com



Meeting Guide

Lunch Entree Salad Creations

(These Lunch Entree Salad Creations are only available for lunchtime meetings.)

Create Your Own Salad!

\$10.95 per person

Ingredients are served buffet style for each guest to "create their own."

Served with rolls & salad dressing.

Caesar

Fresh Chopped Romaine Lettuce

Parmesan Cheese

Croutons

Grilled Chicken

Grilled Steak Tips

Grilled Eggplant, Summer Squash, Zucchini, Roasted Red Pepper,

Portabella Mushrooms, Black Olives & Anchovies

All American

Fresh Wild Greens Salad

Turkey

Ham

Cheddar Cheese

Crumbled Bacon

Hard Boiled Egg

Croutons

Cucumber, Tomato, Mushroom, Onion, Pepper & Avocado

Oriental

Oriental Salad Blend of Green Leaf Lettuce and Bok Choy

Sauteed Shrimp

Sauteed Teriyaki Chicken

Scallions, Water Chestnuts, Bean Sprouts, Chow Mein Noodles, Almonds,

Snow peas, Mandarin Orange Slices & Red Peppers

*18% gratuity and 9% rooms and meals tax additional on all food, beverages and room rental.
Prices subject to change. We regret that banquet food cannot be removed from the premises.*

We serve only Certified Angus Beef® selections.

Lunch Entree Salad Creations are not available for Wedding Receptions.



Pats Peak Banquet Center • Henniker, NH • (603) 428-3245 • patspeak.com

Meeting Guide Hors d'oeuvres Selections

Prices are per person.

Garden Crudite <i>Fresh Raw Vegetable Display with Seasoned Dips.</i>	\$3.00
Gourmet Fromage Display <i>Muenster, Cheddar, Swiss, Pepper Jack, Garlic Herb Spread, Smoked Gouda, Dill Havarti, Pepperoni, Salami, Fresh Fruit including Grapes, Strawberries & Melon with Assorted Crackers.</i>	\$4.00
Flat Bread Alfredo Pizza <i>Alfredo Sauce, Fresh Tomato & Fresh Basil.</i>	\$3.00
Meatballs <i>Select One ~ Italian, Swedish, BBQ, Sweet and Sour</i> <i>Select Two ~ Italian, Swedish, BBQ, Sweet and Sour</i>	\$3.00 \$3.25
Stuffed Mushroom Caps <i>Select One ~ Crab Almond, Spinach Feta, Mild Italian, Spicy Cajun</i> <i>Select Two ~ Crab Almond, Spinach Feta, Mild Italian, Spicy Cajun</i>	\$3.00 \$3.25
Baked Brie <i>Select One ~ Raspberry Almond En Croute, Hazelnut Crusted served with fresh pears</i>	\$4.00
Mediterranean Display <i>Warm Artichoke and Spinach Dip, Hummus and Spanakopita accompanied by crackers and bread.</i>	\$4.00
Chicken Satay <i>Marinated Chicken Grilled and Served with a peanut sauce.</i>	\$4.00
Mini Crab Cakes <i>Homemade mini Crab Cakes served with a horseradish mayonaise sauce.</i>	\$4.50
Teriyaki Steak Skewers <i>Marinated Steak Skewers served with a teriyaki dipping sauce.</i>	\$4.50
Shrimp Cocktail <i>Large Shrimp served cool and crisp with cocktail sauce.</i>	\$5.00
Scallops Wrapped in Bacon <i>Fresh Scallops wrapped in bacon and baked. Brushed with a maple syrup glaze.</i>	\$5.00

**Most Hors d'oeuvres can be passed upon request.*

*18% gratuity and 9% rooms and meals tax additional on all food, beverages and room rental.
Prices subject to change. We regret that banquet food cannot be removed from the premises.*

We serve only Certified Angus Beef® selections.



Pats Peak Banquet Center • Henniker, NH • (603) 428-3245 • patspeak.com

Dessert Selections

*Prices are per person,
per Dessert Selection.*

<i>Chocolate Dipped Strawberries</i>	<i>\$4.00</i>
<i>Vanilla Cream Puffs Laced with Chocolate</i>	<i>\$4.00</i>
<i>Fruit Filled Crepes</i>	<i>\$4.00</i>
<i>Almond Joy Tart</i>	<i>\$4.00</i>
<i>Brownie Sundae</i>	<i>\$4.00</i>
<i>Assorted Cheesecake</i>	<i>\$4.00</i>
<i>Tiramisu</i>	<i>\$3.75</i>
<i>Strawberry Shortcake</i>	<i>\$3.50</i>
<i>Brownie</i>	<i>\$3.50</i>
<i>Carrot Cake</i>	<i>\$3.50</i>
<i>Fresh Fruit Platter</i>	<i>\$3.50</i>
<i>Assorted Cookie Tray</i>	<i>\$3.00</i>
<i>Apple Crisp</i>	<i>\$3.00</i>
<i>Apple Pie</i>	<i>\$3.00</i>

Chocolate Fountains available - Please inquire if interested.

18% gratuity and 9% rooms and meals tax additional on all food, beverages and room rental.

Prices subject to change.

We regret that banquet food can not be removed from the premises.



Pats Peak Banquet Center • Henniker, NH • (603) 428-3245 • patspeak.com

Beverage Selections

We serve a full range of spirits, wines and beer.

*You may arrange for a full open bar, limited open bar, or a cash bar,
whatever meets your needs.*

Liquor Prices

<i>Domestic & Imported Draft Beer</i>	<i>\$4.25 to \$7.25</i>
<i>Bottle Beer (Valley Room Only)</i>	<i>\$4.75 to \$6.25</i>
<i>House Wine</i>	<i>\$5.00</i>
<i>Soda</i>	<i>\$1.75</i>
<i>Juice</i>	<i>\$1.75</i>
<i>Mixed Drinks</i>	<i>\$5.00 to \$7.00</i>

Champagne Toasts

<i>Domestic Champagne</i>	<i>\$3.00 per person</i>
<i>Non-Alcoholic Sparkling Cider or Grape</i>	<i>\$3.00 per person</i>
<i>Imported Champagne</i>	<i>\$4.00 per person</i>

Punch Bowls

<i>Spirited Bowl (serves 30)</i>	<i>\$85.00</i>
<i>Non-Spirited Bowl (serves 30)</i>	<i>\$50.00</i>

18% gratuity and 9% rooms and meals tax additional on all food, beverages and room rental.

Prices subject to change.

Beverage Policy ~ Pats Peak's managers, bartenders and servers are trained in responsible beverage service and if necessary will deny service to anyone that, in their opinion, appears to have consumed more alcohol than is considered safe and responsible. Under no circumstances will anyone under 21 years old be served. In accordance with NH State Law, no alcohol is allowed to be brought onto or leave the premises by guests.



PATS PEAK

Pats Peak Banquet Center • Henniker, NH • (603) 428-3245 • patspeak.com

Midweek Corporate Meetings/Workshops

*For midweek corporate meetings/workshops, the Rental Fee is based on an (8) eight-hour time period.
Fees Subject To Change.*

*Rental Fee includes Linens, Set-Up, Clean-Up, Coffee and Tea Station,
Full China Setting including Water Goblet, Luncheon Plate, Salad Plate & Silverware.*

<u>Room</u>	<u>Rental Fee with Food Purchase</u>	<u>Rental Fee with No Food Purchase</u>
<i>Sleigh Room (includes Sled Pub)</i>	\$200	\$500
<i>Valley Room</i>	\$200	\$500

**Greater Concord Chamber of Commerce Members and Henniker Chamber of Commerce Members
receive a discounted rate, please inquire if you are a member.*

Audio Visual Equipment

Limited Audio Visual available onsite.

Please let us know what you need for your event and we will do our best to provide it for you.

Some items may require an additional rental fee.

Screen

Podium

Microphone

Television

DVD

VCR

Terms and Conditions

Subject To Change

- A \$500 Non-Refundable/Non-Transferable Deposit and Signed Contract will secure the date of your choice.*
- We require 50% payment of your Estimated Bill (1) One Month prior to your event. Cancellation within 30 days or less of scheduled event will result in forfeiture of 50% of total balance of estimated invoice.*
- The Final Menu Selections, Confirmed Numbers and Final Balance due (2) Two Weeks prior to your event. Cancellation within 14 days or less of scheduled event will result in forfeiture of 100% of total balance of final invoice.*
- MasterCard, Visa and American Express credit cards are welcomed.*
- 18% gratuity and 9% rooms and meals tax additional on all food, beverages, and room rental.*



Directions To Pats Peak Banquet Center

686 Flanders Road, Henniker, NH 03242

*“The Only Henniker On Earth”
Conveniently located in Southern NH off I-89*

From Manchester, NH

40 Minutes

Take I-93 North to Concord, NH. Take I-89 North. Take Exit 5 (a left hand exit). Follow Route 202/9 West. Take the Henniker Exit (Route 114). Follow Route 114 South. Go straight through the center of town for approximately 2 miles and look for the Pats Peak sign on your right. Take the right and follow the road to the Pats Peak entrance.

From Boston, MA

1 1/2 Hours

Take I-93 North to Concord, NH. Take I-89 North. Take Exit 5 (a left hand exit). Follow Route 202/9 West. Take the Henniker Exit (Route 114). Follow Route 114 South. Go straight through the center of town for approximately 2 miles and look for the Pats Peak sign on your right. Take the right and follow the road to the Pats Peak entrance.

From Burlington, VT

2 Hours

Take I-89 South to Exit 5 (Route 202/9 West). Proceed on Route 202/9 West to the Henniker Exit (Route 114). Follow Route 114 South. Go straight through the center of town for approximately 2 miles and look for Pats Peak on your right. Take the right and follow the road to the Pats Peak entrance.

From Brattleboro, VT

1 1/4 Hours

Take Route 9 East to Henniker. Take the Henniker Exit (Route 114). Follow Route 114 South. Go straight through the center of town for approximately 2 miles and look for the Pats Peak sign on your right. Take the right and follow the road to the Pats Peak entrance.

From Portsmouth, NH

1 1/4 Hours

Take Route 4 West to Concord, NH. Merge onto I-393 West/US-202 West/US-4 West toward I-93. Take I-93 South toward I-89. Take I-89 North. Take Exit 5 (a left hand exit). Follow Route 202/9 West. Take the Henniker Exit (Route 114). Follow Route 114 South. Go straight through the center of town for approximately 2 miles and look for the Pats Peak sign on your right. Take the right and follow the road to the Pats Peak entrance.



PATS PEAK

Pats Peak Banquet Center • Henniker, NH • (603) 428-3245 • patspeak.com

Pats Peak Banquet Center Floor Plans

Pats Peak Base Area

Main Lodge and Valley Lodge

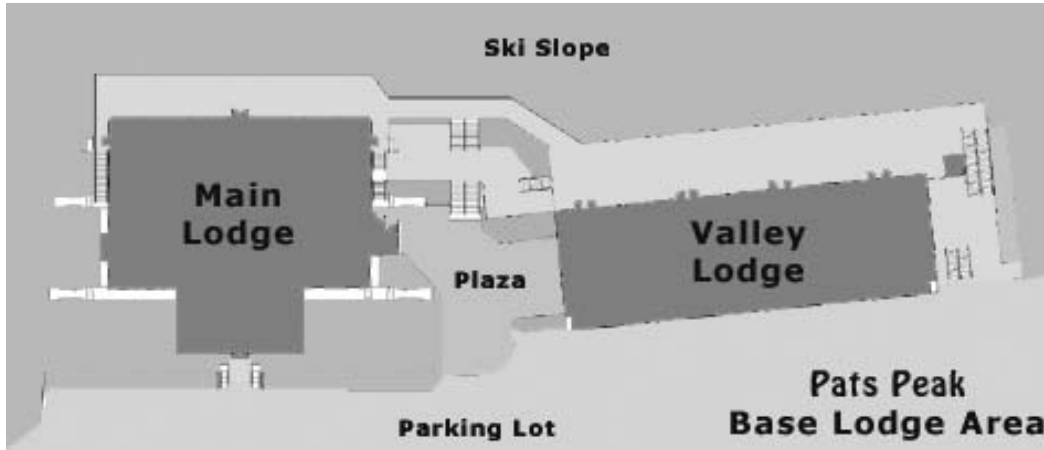

The Valley Room

Located in the Valley Lodge

*Air Conditioning, Beautiful Large Windows,
Space for Dining and Dancing, Cocktail Area, Large Slope Side Deck*

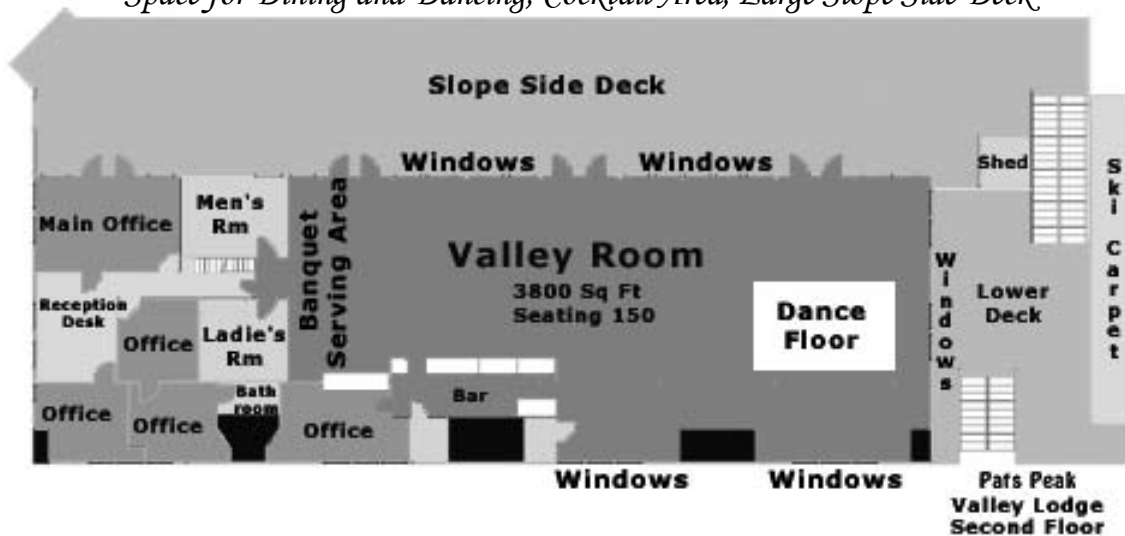

Pats Peak Banquet Center Floor Plans

Sleigh Room and Sled Pub

Located on the Third Floor of the Main Lodge

Air Conditioning, Beautiful Stone Fireplace, Space for Dining and Dancing,
Adjacent Sled Pub Lounge Area, Large Sun Deck

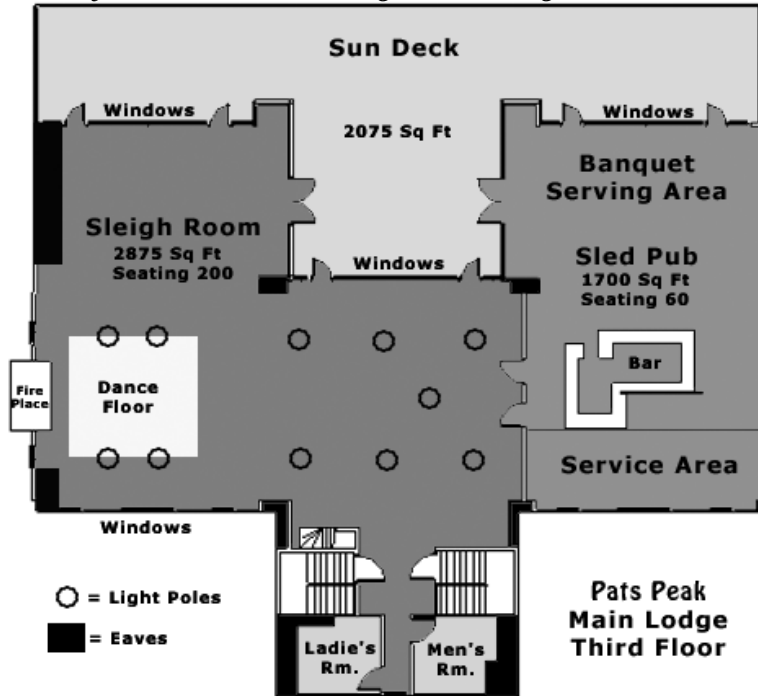

Oak Room

Located on the Second Floor of the Main Lodge

Beautiful Stone Fireplace, Indoor Wedding Ceremony Location



Corporate Meetings

*Anything We Can Do To Make Your Day Unique
And Memorable Is Our Pleasure!*



- ◆ *Personalized Service*
- ◆ *Air Conditioned Facility*
- ◆ *Rooms Can Be Arranged in Many Styles*
- ◆ *Wireless Internet Access*
- ◆ *Quiet Retreat Setting*



Thank You For Considering Pats Peak Banquet Center

Enclosed you will find helpful information on planning your meeting or workshop at Pats Peak along with our menu selections. Please remember, you are not limited to the menu selections listed. We will "cater" to your every whim! Pats Peak regularly accommodates menu requests of all types. If you have special religious or dietary needs or simply prefer another selection, Pats Peak's Banquet Staff is happy to serve you.

Choose from two air-conditioned rooms. Our rooms can be arranged in many styles with podium and microphone capabilities. Audio-visual equipment is available, please be sure to let us know your AV needs in advance. Wireless Internet Access is available in both lodges. Large wooden decks face the mountain offering spectacular views and a tranquil setting.

If you haven't done so already, please contact me to make arrangements to view our Banquet Center in person. Remember, "Personalized Service" is what makes Pats Peak a favorite meeting location. Anything our staff can do to make your day unique and memorable is our pleasure!

Sincerely,



*Jessica Gilbert
Pats Peak Banquet Center
1-888-PATS PEAK ext. 123
(603) 428-3245, ext. 123*



Meeting Guide Breakfast Selections

Prices are per person.

Continental Breakfast

\$5.95 per person

Muffins

Danishes

Bagels

Selection of Cream Cheeses and Jellies

Assorted Juices

Coffee

Tea

Breakfast Buffet

\$9.95 per person

Scrambled Eggs

French Toast

Bacon

Sausage

Home Fries

Muffins

Danishes

Assorted Juices

Coffee

Tea

18% gratuity and 9% rooms and meals tax additional on all food, beverages and room rental.

Prices subject to change.

We regret that banquet food can not be removed from the premises.

Breakfast Selections are not available for Wedding Receptions.

Pats Peak Banquet Center • Henniker, NH • (603) 428-3245 • patspeak.com



Banquet Full-Service Buffet Lunch Entree Selections

Prices are per person and include a choice of salad and dinner rolls.

If selecting (2) Lunch Entree Selections, add an additional \$4.00 per person to the higher priced lunch entree selection.

Sautéed Steak Tips with Red Wine Sauce <i>Served with Caramelized Onions, Rice Pilaf and Seasonal Vegetables.</i>	\$14.95
Grilled Salmon with Herb Butter <i>Served with Rice Pilaf and Seasonal Vegetables.</i>	\$14.95
Baked Haddock <i>Seasoned Bread Crumbs with an Herb Cream Sauce. Served with Rice Pilaf and Seasonal Vegetables.</i>	\$14.95
Lasagna <i>Select One ~ Vegetarian or Meat.</i>	\$12.95
Grilled Herbed Boneless Chicken Breast <i>Served with Rice Pilaf and Seasonal Vegetables.</i>	\$12.95
Chicken Parmesan <i>Served with Pasta and Marinara Sauce.</i>	\$12.95
Chicken & Broccoli Alfredo <i>Served with Pasta.</i>	\$12.95
Chicken Quesadilla <i>Served with Salsa, Sour Cream & Guacamole.</i>	\$10.95
Pasta Bar <i>Served with (2) selections of sauces, grilled chicken, grilled vegetables and parmesan cheese.</i>	\$10.95
Teriyaki Chicken <i>Served with rice.</i>	\$10.95
Homemade Chili <i>Served in a taco bowl with sour cream & scallions.</i>	\$9.95
8 oz. Angus Burger <i>Served with french fries.</i>	\$9.75
Soup & Salad <i>Choice of Soup and Salad.</i>	\$9.50

18% gratuity and 9% rooms and meals tax additional on all food, beverages and room rental.
Prices subject to change. We regret that banquet food cannot be removed from the premises.

We serve only Certified Angus Beef® selections.

Lunch Selections are not available for Wedding Receptions.

Pats Peak Banquet Center • Henniker, NH • (603) 428-3245 • patspeak.com



Selections to Accompany Buffet Lunch Entree

Potato / Rice

Select One

Red Roasted Potato with Garlic and Herbs
Sautéed New Potato with Fresh Dill and Onions
Baked Potato with Sour Cream and Chives
Mashed Potato
Garlic Mashed Potato
Rice Pilaf

Vegetable

Select One

Mélange - Carrots, Broccoli, Cauliflower
Glazed Carrots
Green Beans Almondine with Onion and Red Pepper
Baked Squash with Maple Syrup Sauce
Broccoli Stir Fry
Summer Squash Medley

Salad

Select One

Caesar Salad
Garden Salad
Spinach Salad
Wild Greens Salad

Pasta Sides

Add additional \$4.00 per side, per person to the entree selection price.

Tortellini Alfredo
Penne with Sausage & Peppers
Stuffed Manicotti
Pasta Primavera ~ Pesto Sauce and Vegetables
Roma ~ Roasted Garlic Cream with Red Pepper and Fresh Basil
Vegetable Lasagna
Meat Lasagna
Ravioli



PATS PEAK

Pats Peak Banquet Center • Henniker, NH • (603) 428-3245 • patspeak.com

Meeting Guide Lunch Platter Selections

Prices are per person. All Sandwich Platters are served with Chips and Pickles.
Add \$1.00 per person for French Fries.

(These Lunch Platter Selections are only available for lunchtime meetings.)

Over-Stuffed Finger Sandwich Platter

\$7.95 per person

Tuna Salad

Chicken Salad

Egg Salad

Ham Salad

Assorted Wrap Platter

Select Three

\$9.95 per person

Southwestern Chicken

Seasoned Chicken, Sautéed Peppers & Onions, with Tangy Southwestern Ranch Sauce.

Roast Beef

Served with Horseradish Mustard Sauce.

Roast Turkey

Served with Lettuce, Tomato and Mayonnaise.

Smoked Ham & Swiss

Served with Honey Mustard Sauce.

Hummus, Sprouts & Red Onion

Served with Roasted Red Pepper & Spinach.

Grilled Chicken Caesar

Grilled Chicken with Classic Caesar Salad.

Italian

Salami, Ham, Tomato, Provolone Cheese & Pesto.

Gourmet Sandwich Platter

Your choice of Baguette, Croissant, Kaiser Roll or Focaccia.

Select Three

\$10.95 per person

Smoked Turkey, Smoked Bacon, Cheddar Cheese

Prosciutto, Salami, Provolone, Roasted Red Pepper, Tomato, Onion Aioli & Pesto Dressing

Grilled Chicken Roma, Sundried Tomatoes, Imported Olives, Roasted Shallot Herb Spread

Grilled Portabella Mushrooms, Zucchini, Eggplant, Roasted Garlic, Fresh Mozzarella

Seafood Salad with Herb Mayonnaise & Lettuce

French Dip with Thinly Sliced Roast Beef Au Jus

18% gratuity and 9% rooms and meals tax additional on all food, beverages and room rental.

Prices subject to change.

We regret that banquet food can not be removed from the premises.

Lunch Platter Selections are not available for Wedding Receptions

Pats Peak Banquet Center • Henniker, NH • (603) 428-3245 • patspeak.com



Meeting Guide

Lunch Soup Selections

*\$5.00 per person,
per Soup Selection.*

New England Clam Chowder

Seafood Chowder

Grilled Chicken & Corn Chowder

Cream of Broccoli

Garden Vegetable

Tomato Tortellini

Lunch Salad Selections

*\$4.50 per person,
per Salad Selection.*

Potato & Egg Salad

Mixed Baby Green Salad

Caesar Salad

Coleslaw or Broccoli Slaw

Pepper Pasta Salad

Summer Salad ~ Fresh Mozzarella, Tomato, Balsamic Vinaigrette, Over Lettuce

Spinach Salad ~ Mushroom, Egg, Tomato, Bacon, Red Onion and Red Pepper

18% gratuity and 9% rooms and meals tax additional on all food, beverages and room rental.

Prices subject to change.

We regret that banquet food can not be removed from the premises.

Lunch Selections are only available for lunchtime meetings and not available for Wedding Receptions.

Pats Peak Banquet Center • Henniker, NH • (603) 428-3245 • patspeak.com



Meeting Guide

Lunch Entree Salad Creations

(These Lunch Entree Salad Creations are only available for lunchtime meetings.)

Create Your Own Salad!

\$10.95 per person

Ingredients are served buffet style for each guest to "create their own."

Served with rolls & salad dressing.

Caesar

Fresh Chopped Romaine Lettuce

Parmesan Cheese

Croutons

Grilled Chicken

Grilled Steak Tips

Grilled Eggplant, Summer Squash, Zucchini, Roasted Red Pepper,

Portabella Mushrooms, Black Olives & Anchovies

All American

Fresh Wild Greens Salad

Turkey

Ham

Cheddar Cheese

Crumbled Bacon

Hard Boiled Egg

Croutons

Cucumber, Tomato, Mushroom, Onion, Pepper & Avocado

Oriental

Oriental Salad Blend of Green Leaf Lettuce and Bok Choy

Sauteed Shrimp

Sauteed Teriyaki Chicken

Scallions, Water Chestnuts, Bean Sprouts, Chow Mein Noodles, Almonds,

Snow peas, Mandarin Orange Slices & Red Peppers

*18% gratuity and 9% rooms and meals tax additional on all food, beverages and room rental.
Prices subject to change. We regret that banquet food cannot be removed from the premises.*

We serve only Certified Angus Beef® selections.

Lunch Entree Salad Creations are not available for Wedding Receptions.



Pats Peak Banquet Center • Henniker, NH • (603) 428-3245 • patspeak.com

Meeting Guide Hors d'oeuvres Selections

Prices are per person.

Garden Crudite <i>Fresh Raw Vegetable Display with Seasoned Dips.</i>	\$3.00
Gourmet Fromage Display <i>Muenster, Cheddar, Swiss, Pepper Jack, Garlic Herb Spread, Smoked Gouda, Dill Havarti, Pepperoni, Salami, Fresh Fruit including Grapes, Strawberries & Melon with Assorted Crackers.</i>	\$4.00
Flat Bread Alfredo Pizza <i>Alfredo Sauce, Fresh Tomato & Fresh Basil.</i>	\$3.00
Meatballs <i>Select One ~ Italian, Swedish, BBQ, Sweet and Sour</i> <i>Select Two ~ Italian, Swedish, BBQ, Sweet and Sour</i>	\$3.00 \$3.25
Stuffed Mushroom Caps <i>Select One ~ Crab Almond, Spinach Feta, Mild Italian, Spicy Cajun</i> <i>Select Two ~ Crab Almond, Spinach Feta, Mild Italian, Spicy Cajun</i>	\$3.00 \$3.25
Baked Brie <i>Select One ~ Raspberry Almond En Croute, Hazelnut Crusted served with fresh pears</i>	\$4.00
Mediterranean Display <i>Warm Artichoke and Spinach Dip, Hummus and Spanakopita accompanied by crackers and bread.</i>	\$4.00
Chicken Satay <i>Marinated Chicken Grilled and Served with a peanut sauce.</i>	\$4.00
Mini Crab Cakes <i>Homemade mini Crab Cakes served with a horseradish mayonaise sauce.</i>	\$4.50
Teriyaki Steak Skewers <i>Marinated Steak Skewers served with a teriyaki dipping sauce.</i>	\$4.50
Shrimp Cocktail <i>Large Shrimp served cool and crisp with cocktail sauce.</i>	\$5.00
Scallops Wrapped in Bacon <i>Fresh Scallops wrapped in bacon and baked. Brushed with a maple syrup glaze.</i>	\$5.00

**Most Hors d'oeuvres can be passed upon request.*

*18% gratuity and 9% rooms and meals tax additional on all food, beverages and room rental.
Prices subject to change. We regret that banquet food cannot be removed from the premises.*

We serve only Certified Angus Beef® selections.



Pats Peak Banquet Center • Henniker, NH • (603) 428-3245 • patspeak.com

Dessert Selections

*Prices are per person,
per Dessert Selection.*

<i>Chocolate Dipped Strawberries</i>	<i>\$4.00</i>
<i>Vanilla Cream Puffs Laced with Chocolate</i>	<i>\$4.00</i>
<i>Fruit Filled Crepes</i>	<i>\$4.00</i>
<i>Almond Joy Tart</i>	<i>\$4.00</i>
<i>Brownie Sundae</i>	<i>\$4.00</i>
<i>Assorted Cheesecake</i>	<i>\$4.00</i>
<i>Tiramisu</i>	<i>\$3.75</i>
<i>Strawberry Shortcake</i>	<i>\$3.50</i>
<i>Brownie</i>	<i>\$3.50</i>
<i>Carrot Cake</i>	<i>\$3.50</i>
<i>Fresh Fruit Platter</i>	<i>\$3.50</i>
<i>Assorted Cookie Tray</i>	<i>\$3.00</i>
<i>Apple Crisp</i>	<i>\$3.00</i>
<i>Apple Pie</i>	<i>\$3.00</i>

Chocolate Fountains available - Please inquire if interested.

18% gratuity and 9% rooms and meals tax additional on all food, beverages and room rental.

Prices subject to change.

We regret that banquet food can not be removed from the premises.



Pats Peak Banquet Center • Henniker, NH • (603) 428-3245 • patspeak.com

Beverage Selections

We serve a full range of spirits, wines and beer.

*You may arrange for a full open bar, limited open bar, or a cash bar,
whatever meets your needs.*

Liquor Prices

<i>Domestic & Imported Draft Beer</i>	<i>\$4.25 to \$7.25</i>
<i>Bottle Beer (Valley Room Only)</i>	<i>\$4.75 to \$6.25</i>
<i>House Wine</i>	<i>\$5.00</i>
<i>Soda</i>	<i>\$1.75</i>
<i>Juice</i>	<i>\$1.75</i>
<i>Mixed Drinks</i>	<i>\$5.00 to \$7.00</i>

Champagne Toasts

<i>Domestic Champagne</i>	<i>\$3.00 per person</i>
<i>Non-Alcoholic Sparkling Cider or Grape</i>	<i>\$3.00 per person</i>
<i>Imported Champagne</i>	<i>\$4.00 per person</i>

Punch Bowls

<i>Spirited Bowl (serves 30)</i>	<i>\$85.00</i>
<i>Non-Spirited Bowl (serves 30)</i>	<i>\$50.00</i>

18% gratuity and 9% rooms and meals tax additional on all food, beverages and room rental.

Prices subject to change.

Beverage Policy ~ Pats Peak's managers, bartenders and servers are trained in responsible beverage service and if necessary will deny service to anyone that, in their opinion, appears to have consumed more alcohol than is considered safe and responsible. Under no circumstances will anyone under 21 years old be served. In accordance with NH State Law, no alcohol is allowed to be brought onto or leave the premises by guests.



Midweek Corporate Meetings/Workshops

*For midweek corporate meetings/workshops, the Rental Fee is based on an (8) eight-hour time period.
Fees Subject To Change.*

*Rental Fee includes Linens, Set-Up, Clean-Up, Coffee and Tea Station,
Full China Setting including Water Goblet, Luncheon Plate, Salad Plate & Silverware.*

<u>Room</u>	<u>Rental Fee with Food Purchase</u>	<u>Rental Fee with No Food Purchase</u>
<i>Sleigh Room (includes Sled Pub)</i>	\$200	\$500
<i>Valley Room</i>	\$200	\$500

**Greater Concord Chamber of Commerce Members and Henniker Chamber of Commerce Members
receive a discounted rate, please inquire if you are a member.*

Audio Visual Equipment

Limited Audio Visual available onsite.

Please let us know what you need for your event and we will do our best to provide it for you.

Some items may require an additional rental fee.

Screen

Podium

Microphone

Television

DVD

VCR

Terms and Conditions

Subject To Change

- A \$500 Non-Refundable/Non-Transferable Deposit and Signed Contract will secure the date of your choice.*
- We require 50% payment of your Estimated Bill (1) One Month prior to your event. Cancellation within 30 days or less of scheduled event will result in forfeiture of 50% of total balance of estimated invoice.*
- The Final Menu Selections, Confirmed Numbers and Final Balance due (2) Two Weeks prior to your event. Cancellation within 14 days or less of scheduled event will result in forfeiture of 100% of total balance of final invoice.*
- MasterCard, Visa and American Express credit cards are welcomed.*
- 18% gratuity and 9% rooms and meals tax additional on all food, beverages, and room rental.*



Directions To Pats Peak Banquet Center

686 Flanders Road, Henniker, NH 03242

“The Only Henniker On Earth”

Conveniently located in Southern NH off I-89

From Manchester, NH

40 Minutes

Take I-93 North to Concord, NH. Take I-89 North. Take Exit 5 (a left hand exit). Follow Route 202/9 West. Take the Henniker Exit (Route 114). Follow Route 114 South. Go straight through the center of town for approximately 2 miles and look for the Pats Peak sign on your right. Take the right and follow the road to the Pats Peak entrance.

From Boston, MA

1 1/2 Hours

Take I-93 North to Concord, NH. Take I-89 North. Take Exit 5 (a left hand exit). Follow Route 202/9 West. Take the Henniker Exit (Route 114). Follow Route 114 South. Go straight through the center of town for approximately 2 miles and look for the Pats Peak sign on your right. Take the right and follow the road to the Pats Peak entrance.

From Burlington, VT

2 Hours

Take I-89 South to Exit 5 (Route 202/9 West). Proceed on Route 202/9 West to the Henniker Exit (Route 114). Follow Route 114 South. Go straight through the center of town for approximately 2 miles and look for Pats Peak on your right. Take the right and follow the road to the Pats Peak entrance.

From Brattleboro, VT

1 1/4 Hours

Take Route 9 East to Henniker. Take the Henniker Exit (Route 114). Follow Route 114 South. Go straight through the center of town for approximately 2 miles and look for the Pats Peak sign on your right. Take the right and follow the road to the Pats Peak entrance.

From Portsmouth, NH

1 1/4 Hours

Take Route 4 West to Concord, NH. Merge onto I-393 West/US-202 West/US-4 West toward I-93. Take I-93 South toward I-89. Take I-89 North. Take Exit 5 (a left hand exit). Follow Route 202/9 West. Take the Henniker Exit (Route 114). Follow Route 114 South. Go straight through the center of town for approximately 2 miles and look for the Pats Peak sign on your right. Take the right and follow the road to the Pats Peak entrance.



Pats Peak Banquet Center Floor Plans

Pats Peak Base Area

Main Lodge and Valley Lodge

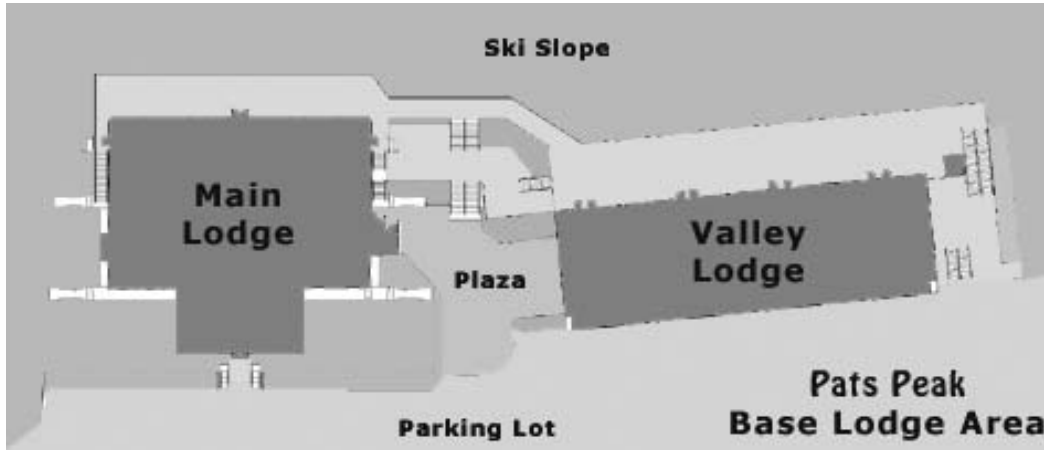

The Valley Room

Located in the Valley Lodge

*Air Conditioning, Beautiful Large Windows,
Space for Dining and Dancing, Cocktail Area, Large Slope Side Deck*

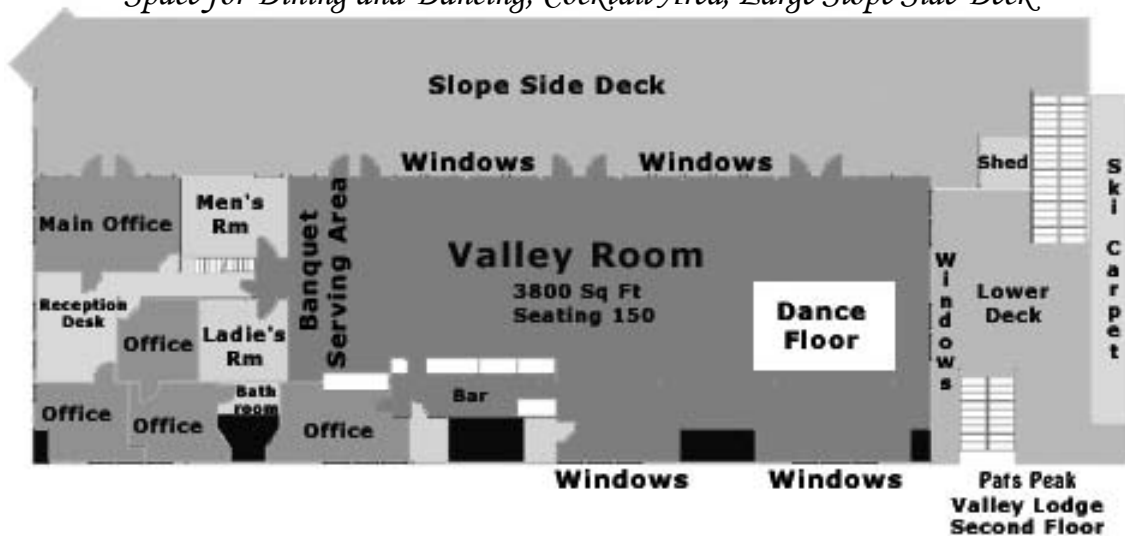

Pats Peak Banquet Center Floor Plans

Sleigh Room and Sled Pub

Located on the Third Floor of the Main Lodge

Air Conditioning, Beautiful Stone Fireplace, Space for Dining and Dancing,
Adjacent Sled Pub Lounge Area, Large Sun Deck

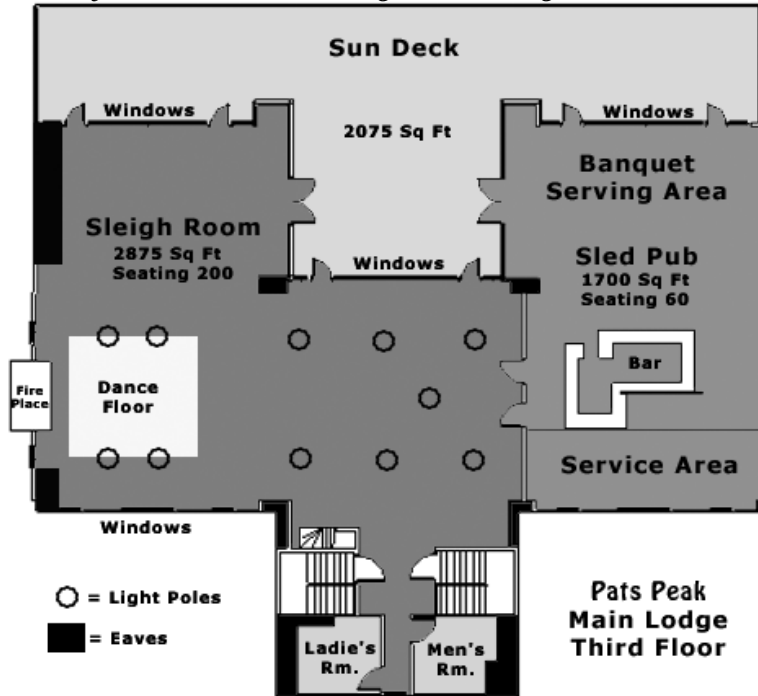

Oak Room

Located on the Second Floor of the Main Lodge

Beautiful Stone Fireplace, Indoor Wedding Ceremony Location



Corporate Meetings

*Anything We Can Do To Make Your Day Unique
And Memorable Is Our Pleasure!*



- ◆ *Personalized Service*
- ◆ *Air Conditioned Facility*
- ◆ *Rooms Can Be Arranged in Many Styles*
- ◆ *Wireless Internet Access*
- ◆ *Quiet Retreat Setting*



Thank You For Considering Pats Peak Banquet Center

Enclosed you will find helpful information on planning your meeting or workshop at Pats Peak along with our menu selections. Please remember, you are not limited to the menu selections listed. We will "cater" to your every whim! Pats Peak regularly accommodates menu requests of all types. If you have special religious or dietary needs or simply prefer another selection, Pats Peak's Banquet Staff is happy to serve you.

Choose from two air-conditioned rooms. Our rooms can be arranged in many styles with podium and microphone capabilities. Audio-visual equipment is available, please be sure to let us know your AV needs in advance. Wireless Internet Access is available in both lodges. Large wooden decks face the mountain offering spectacular views and a tranquil setting.

If you haven't done so already, please contact me to make arrangements to view our Banquet Center in person. Remember, "Personalized Service" is what makes Pats Peak a favorite meeting location. Anything our staff can do to make your day unique and memorable is our pleasure!

Sincerely,



*Jessica Gilbert
Pats Peak Banquet Center
1-888-PATS PEAK ext. 123
(603) 428-3245, ext. 123*



Meeting Guide Breakfast Selections

Prices are per person.

Continental Breakfast

\$5.95 per person

Muffins

Danishes

Bagels

Selection of Cream Cheeses and Jellies

Assorted Juices

Coffee

Tea

Breakfast Buffet

\$9.95 per person

Scrambled Eggs

French Toast

Bacon

Sausage

Home Fries

Muffins

Danishes

Assorted Juices

Coffee

Tea

18% gratuity and 9% rooms and meals tax additional on all food, beverages and room rental.

Prices subject to change.

We regret that banquet food can not be removed from the premises.

Breakfast Selections are not available for Wedding Receptions.

Pats Peak Banquet Center • Henniker, NH • (603) 428-3245 • patspeak.com



Banquet Full-Service Buffet Lunch Entree Selections

Prices are per person and include a choice of salad and dinner rolls.

If selecting (2) Lunch Entree Selections, add an additional \$4.00 per person to the higher priced lunch entree selection.

Sautéed Steak Tips with Red Wine Sauce <i>Served with Caramelized Onions, Rice Pilaf and Seasonal Vegetables.</i>	\$14.95
Grilled Salmon with Herb Butter <i>Served with Rice Pilaf and Seasonal Vegetables.</i>	\$14.95
Baked Haddock <i>Seasoned Bread Crumbs with an Herb Cream Sauce. Served with Rice Pilaf and Seasonal Vegetables.</i>	\$14.95
Lasagna <i>Select One ~ Vegetarian or Meat.</i>	\$12.95
Grilled Herbed Boneless Chicken Breast <i>Served with Rice Pilaf and Seasonal Vegetables.</i>	\$12.95
Chicken Parmesan <i>Served with Pasta and Marinara Sauce.</i>	\$12.95
Chicken & Broccoli Alfredo <i>Served with Pasta.</i>	\$12.95
Chicken Quesadilla <i>Served with Salsa, Sour Cream & Guacamole.</i>	\$10.95
Pasta Bar <i>Served with (2) selections of sauces, grilled chicken, grilled vegetables and parmesan cheese.</i>	\$10.95
Teriyaki Chicken <i>Served with rice.</i>	\$10.95
Homemade Chili <i>Served in a taco bowl with sour cream & scallions.</i>	\$9.95
8 oz. Angus Burger <i>Served with french fries.</i>	\$9.75
Soup & Salad <i>Choice of Soup and Salad.</i>	\$9.50

18% gratuity and 9% rooms and meals tax additional on all food, beverages and room rental.
Prices subject to change. We regret that banquet food cannot be removed from the premises.

We serve only Certified Angus Beef® selections.

Lunch Selections are not available for Wedding Receptions.

Pats Peak Banquet Center • Henniker, NH • (603) 428-3245 • patspeak.com



Selections to Accompany Buffet Lunch Entree

Potato / Rice

Select One

Red Roasted Potato with Garlic and Herbs
Sautéed New Potato with Fresh Dill and Onions
Baked Potato with Sour Cream and Chives
Mashed Potato
Garlic Mashed Potato
Rice Pilaf

Vegetable

Select One

Mélange - Carrots, Broccoli, Cauliflower
Glazed Carrots
Green Beans Almondine with Onion and Red Pepper
Baked Squash with Maple Syrup Sauce
Broccoli Stir Fry
Summer Squash Medley

Salad

Select One

Caesar Salad
Garden Salad
Spinach Salad
Wild Greens Salad

Pasta Sides

Add additional \$4.00 per side, per person to the entree selection price.

Tortellini Alfredo
Penne with Sausage & Peppers
Stuffed Manicotti
Pasta Primavera ~ Pesto Sauce and Vegetables
Roma ~ Roasted Garlic Cream with Red Pepper and Fresh Basil
Vegetable Lasagna
Meat Lasagna
Ravioli



Meeting Guide Lunch Platter Selections

Prices are per person. All Sandwich Platters are served with Chips and Pickles.
Add \$1.00 per person for French Fries.

(These Lunch Platter Selections are only available for lunchtime meetings.)

Over-Stuffed Finger Sandwich Platter

\$7.95 per person

Tuna Salad

Chicken Salad

Egg Salad

Ham Salad

Assorted Wrap Platter

Select Three

\$9.95 per person

Southwestern Chicken

Seasoned Chicken, Sautéed Peppers & Onions, with Tangy Southwestern Ranch Sauce.

Roast Beef

Served with Horseradish Mustard Sauce.

Roast Turkey

Served with Lettuce, Tomato and Mayonnaise.

Smoked Ham & Swiss

Served with Honey Mustard Sauce.

Hummus, Sprouts & Red Onion

Served with Roasted Red Pepper & Spinach.

Grilled Chicken Caesar

Grilled Chicken with Classic Caesar Salad.

Italian

Salami, Ham, Tomato, Provolone Cheese & Pesto.

Gourmet Sandwich Platter

Your choice of Baguette, Croissant, Kaiser Roll or Focaccia.

Select Three

\$10.95 per person

Smoked Turkey, Smoked Bacon, Cheddar Cheese

Prosciutto, Salami, Provolone, Roasted Red Pepper, Tomato, Onion Aioli & Pesto Dressing

Grilled Chicken Roma, Sundried Tomatoes, Imported Olives, Roasted Shallot Herb Spread

Grilled Portabella Mushrooms, Zucchini, Eggplant, Roasted Garlic, Fresh Mozzarella

Seafood Salad with Herb Mayonnaise & Lettuce

French Dip with Thinly Sliced Roast Beef Au Jus

18% gratuity and 9% rooms and meals tax additional on all food, beverages and room rental.

Prices subject to change.

We regret that banquet food can not be removed from the premises.

Lunch Platter Selections are not available for Wedding Receptions

Pats Peak Banquet Center • Henniker, NH • (603) 428-3245 • patspeak.com



Meeting Guide

Lunch Soup Selections

*\$5.00 per person,
per Soup Selection.*

New England Clam Chowder

Seafood Chowder

Grilled Chicken & Corn Chowder

Cream of Broccoli

Garden Vegetable

Tomato Tortellini

Lunch Salad Selections

*\$4.50 per person,
per Salad Selection.*

Potato & Egg Salad

Mixed Baby Green Salad

Caesar Salad

Coleslaw or Broccoli Slaw

Pepper Pasta Salad

Summer Salad ~ Fresh Mozzarella, Tomato, Balsamic Vinaigrette, Over Lettuce

Spinach Salad ~ Mushroom, Egg, Tomato, Bacon, Red Onion and Red Pepper

18% gratuity and 9% rooms and meals tax additional on all food, beverages and room rental.

Prices subject to change.

We regret that banquet food can not be removed from the premises.

Lunch Selections are only available for lunchtime meetings and not available for Wedding Receptions.

Pats Peak Banquet Center • Henniker, NH • (603) 428-3245 • patspeak.com



Meeting Guide

Lunch Entree Salad Creations

(These Lunch Entree Salad Creations are only available for lunchtime meetings.)

Create Your Own Salad!

\$10.95 per person

Ingredients are served buffet style for each guest to "create their own."

Served with rolls & salad dressing.

Caesar

Fresh Chopped Romaine Lettuce

Parmesan Cheese

Croutons

Grilled Chicken

Grilled Steak Tips

Grilled Eggplant, Summer Squash, Zucchini, Roasted Red Pepper,

Portabella Mushrooms, Black Olives & Anchovies

All American

Fresh Wild Greens Salad

Turkey

Ham

Cheddar Cheese

Crumbled Bacon

Hard Boiled Egg

Croutons

Cucumber, Tomato, Mushroom, Onion, Pepper & Avocado

Oriental

Oriental Salad Blend of Green Leaf Lettuce and Bok Choy

Sauteed Shrimp

Sauteed Teriyaki Chicken

Scallions, Water Chestnuts, Bean Sprouts, Chow Mein Noodles, Almonds,

Snow peas, Mandarin Orange Slices & Red Peppers

*18% gratuity and 9% rooms and meals tax additional on all food, beverages and room rental.
Prices subject to change. We regret that banquet food cannot be removed from the premises.*

We serve only Certified Angus Beef® selections.

Lunch Entree Salad Creations are not available for Wedding Receptions.



Pats Peak Banquet Center • Henniker, NH • (603) 428-3245 • patspeak.com

Meeting Guide Hors d'oeuvres Selections

Prices are per person.

Garden Crudite <i>Fresh Raw Vegetable Display with Seasoned Dips.</i>	\$3.00
Gourmet Fromage Display <i>Muenster, Cheddar, Swiss, Pepper Jack, Garlic Herb Spread, Smoked Gouda, Dill Havarti, Pepperoni, Salami, Fresh Fruit including Grapes, Strawberries & Melon with Assorted Crackers.</i>	\$4.00
Flat Bread Alfredo Pizza <i>Alfredo Sauce, Fresh Tomato & Fresh Basil.</i>	\$3.00
Meatballs <i>Select One ~ Italian, Swedish, BBQ, Sweet and Sour</i> <i>Select Two ~ Italian, Swedish, BBQ, Sweet and Sour</i>	\$3.00 \$3.25
Stuffed Mushroom Caps <i>Select One ~ Crab Almond, Spinach Feta, Mild Italian, Spicy Cajun</i> <i>Select Two ~ Crab Almond, Spinach Feta, Mild Italian, Spicy Cajun</i>	\$3.00 \$3.25
Baked Brie <i>Select One ~ Raspberry Almond En Croute, Hazelnut Crusted served with fresh pears</i>	\$4.00
Mediterranean Display <i>Warm Artichoke and Spinach Dip, Hummus and Spanakopita accompanied by crackers and bread.</i>	\$4.00
Chicken Satay <i>Marinated Chicken Grilled and Served with a peanut sauce.</i>	\$4.00
Mini Crab Cakes <i>Homemade mini Crab Cakes served with a horseradish mayonaise sauce.</i>	\$4.50
Teriyaki Steak Skewers <i>Marinated Steak Skewers served with a teriyaki dipping sauce.</i>	\$4.50
Shrimp Cocktail <i>Large Shrimp served cool and crisp with cocktail sauce.</i>	\$5.00
Scallops Wrapped in Bacon <i>Fresh Scallops wrapped in bacon and baked. Brushed with a maple syrup glaze.</i>	\$5.00

**Most Hors d'oeuvres can be passed upon request.*

*18% gratuity and 9% rooms and meals tax additional on all food, beverages and room rental.
Prices subject to change. We regret that banquet food cannot be removed from the premises.*

We serve only Certified Angus Beef® selections.



Pats Peak Banquet Center • Henniker, NH • (603) 428-3245 • patspeak.com

Dessert Selections

*Prices are per person,
per Dessert Selection.*

<i>Chocolate Dipped Strawberries</i>	<i>\$4.00</i>
<i>Vanilla Cream Puffs Laced with Chocolate</i>	<i>\$4.00</i>
<i>Fruit Filled Crepes</i>	<i>\$4.00</i>
<i>Almond Joy Tart</i>	<i>\$4.00</i>
<i>Brownie Sundae</i>	<i>\$4.00</i>
<i>Assorted Cheesecake</i>	<i>\$4.00</i>
<i>Tiramisu</i>	<i>\$3.75</i>
<i>Strawberry Shortcake</i>	<i>\$3.50</i>
<i>Brownie</i>	<i>\$3.50</i>
<i>Carrot Cake</i>	<i>\$3.50</i>
<i>Fresh Fruit Platter</i>	<i>\$3.50</i>
<i>Assorted Cookie Tray</i>	<i>\$3.00</i>
<i>Apple Crisp</i>	<i>\$3.00</i>
<i>Apple Pie</i>	<i>\$3.00</i>

Chocolate Fountains available - Please inquire if interested.

18% gratuity and 9% rooms and meals tax additional on all food, beverages and room rental.

Prices subject to change.

We regret that banquet food can not be removed from the premises.



Pats Peak Banquet Center • Henniker, NH • (603) 428-3245 • patspeak.com

Beverage Selections

We serve a full range of spirits, wines and beer.

*You may arrange for a full open bar, limited open bar, or a cash bar,
whatever meets your needs.*

Liquor Prices

<i>Domestic & Imported Draft Beer</i>	<i>\$4.25 to \$7.25</i>
<i>Bottle Beer (Valley Room Only)</i>	<i>\$4.75 to \$6.25</i>
<i>House Wine</i>	<i>\$5.00</i>
<i>Soda</i>	<i>\$1.75</i>
<i>Juice</i>	<i>\$1.75</i>
<i>Mixed Drinks</i>	<i>\$5.00 to \$7.00</i>

Champagne Toasts

<i>Domestic Champagne</i>	<i>\$3.00 per person</i>
<i>Non-Alcoholic Sparkling Cider or Grape</i>	<i>\$3.00 per person</i>
<i>Imported Champagne</i>	<i>\$4.00 per person</i>

Punch Bowls

<i>Spirited Bowl (serves 30)</i>	<i>\$85.00</i>
<i>Non-Spirited Bowl (serves 30)</i>	<i>\$50.00</i>

18% gratuity and 9% rooms and meals tax additional on all food, beverages and room rental.

Prices subject to change.

Beverage Policy ~ Pats Peak's managers, bartenders and servers are trained in responsible beverage service and if necessary will deny service to anyone that, in their opinion, appears to have consumed more alcohol than is considered safe and responsible. Under no circumstances will anyone under 21 years old be served. In accordance with NH State Law, no alcohol is allowed to be brought onto or leave the premises by guests.



PATS PEAK

Pats Peak Banquet Center • Henniker, NH • (603) 428-3245 • patspeak.com

Midweek Corporate Meetings/Workshops

*For midweek corporate meetings/workshops, the Rental Fee is based on an (8) eight-hour time period.
Fees Subject To Change.*

*Rental Fee includes Linens, Set-Up, Clean-Up, Coffee and Tea Station,
Full China Setting including Water Goblet, Luncheon Plate, Salad Plate & Silverware.*

<u>Room</u>	<u>Rental Fee with Food Purchase</u>	<u>Rental Fee with No Food Purchase</u>
<i>Sleigh Room (includes Sled Pub)</i>	\$200	\$500
<i>Valley Room</i>	\$200	\$500

**Greater Concord Chamber of Commerce Members and Henniker Chamber of Commerce Members
receive a discounted rate, please inquire if you are a member.*

Audio Visual Equipment

Limited Audio Visual available onsite.

Please let us know what you need for your event and we will do our best to provide it for you.

Some items may require an additional rental fee.

Screen

Podium

Microphone

Television

DVD

VCR

Terms and Conditions

Subject To Change

- A \$500 Non-Refundable/Non-Transferable Deposit and Signed Contract will secure the date of your choice.*
- We require 50% payment of your Estimated Bill (1) One Month prior to your event. Cancellation within 30 days or less of scheduled event will result in forfeiture of 50% of total balance of estimated invoice.*
- The Final Menu Selections, Confirmed Numbers and Final Balance due (2) Two Weeks prior to your event. Cancellation within 14 days or less of scheduled event will result in forfeiture of 100% of total balance of final invoice.*
- MasterCard, Visa and American Express credit cards are welcomed.*
- 18% gratuity and 9% rooms and meals tax additional on all food, beverages, and room rental.*



Directions To Pats Peak Banquet Center

686 Flanders Road, Henniker, NH 03242

*“The Only Henniker On Earth”
Conveniently located in Southern NH off I-89*

From Manchester, NH

40 Minutes

Take I-93 North to Concord, NH. Take I-89 North. Take Exit 5 (a left hand exit). Follow Route 202/9 West. Take the Henniker Exit (Route 114). Follow Route 114 South. Go straight through the center of town for approximately 2 miles and look for the Pats Peak sign on your right. Take the right and follow the road to the Pats Peak entrance.

From Boston, MA

1 1/2 Hours

Take I-93 North to Concord, NH. Take I-89 North. Take Exit 5 (a left hand exit). Follow Route 202/9 West. Take the Henniker Exit (Route 114). Follow Route 114 South. Go straight through the center of town for approximately 2 miles and look for the Pats Peak sign on your right. Take the right and follow the road to the Pats Peak entrance.

From Burlington, VT

2 Hours

Take I-89 South to Exit 5 (Route 202/9 West). Proceed on Route 202/9 West to the Henniker Exit (Route 114). Follow Route 114 South. Go straight through the center of town for approximately 2 miles and look for Pats Peak on your right. Take the right and follow the road to the Pats Peak entrance.

From Brattleboro, VT

1 1/4 Hours

Take Route 9 East to Henniker. Take the Henniker Exit (Route 114). Follow Route 114 South. Go straight through the center of town for approximately 2 miles and look for the Pats Peak sign on your right. Take the right and follow the road to the Pats Peak entrance.

From Portsmouth, NH

1 1/4 Hours

Take Route 4 West to Concord, NH. Merge onto I-393 West/US-202 West/US-4 West toward I-93. Take I-93 South toward I-89. Take I-89 North. Take Exit 5 (a left hand exit). Follow Route 202/9 West. Take the Henniker Exit (Route 114). Follow Route 114 South. Go straight through the center of town for approximately 2 miles and look for the Pats Peak sign on your right. Take the right and follow the road to the Pats Peak entrance.



Pats Peak Banquet Center Floor Plans

Pats Peak Base Area

Main Lodge and Valley Lodge

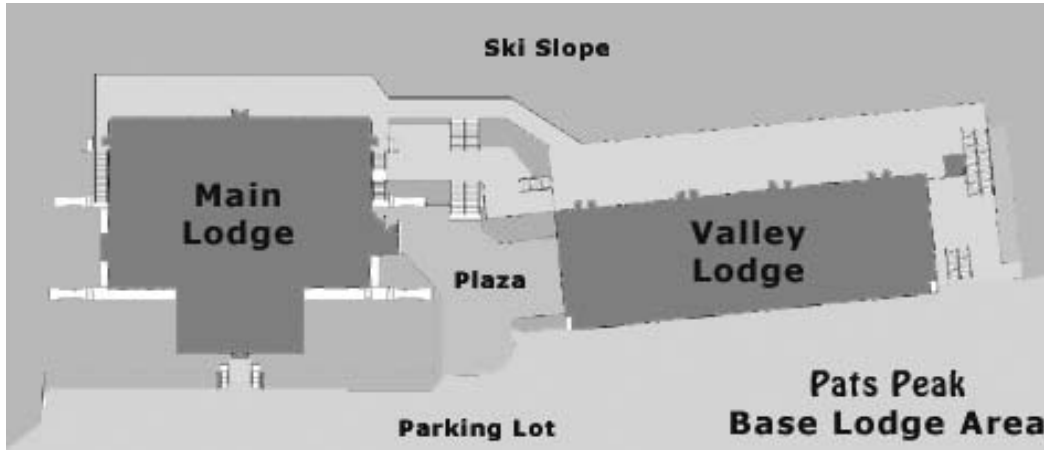

The Valley Room

Located in the Valley Lodge

*Air Conditioning, Beautiful Large Windows,
Space for Dining and Dancing, Cocktail Area, Large Slope Side Deck*

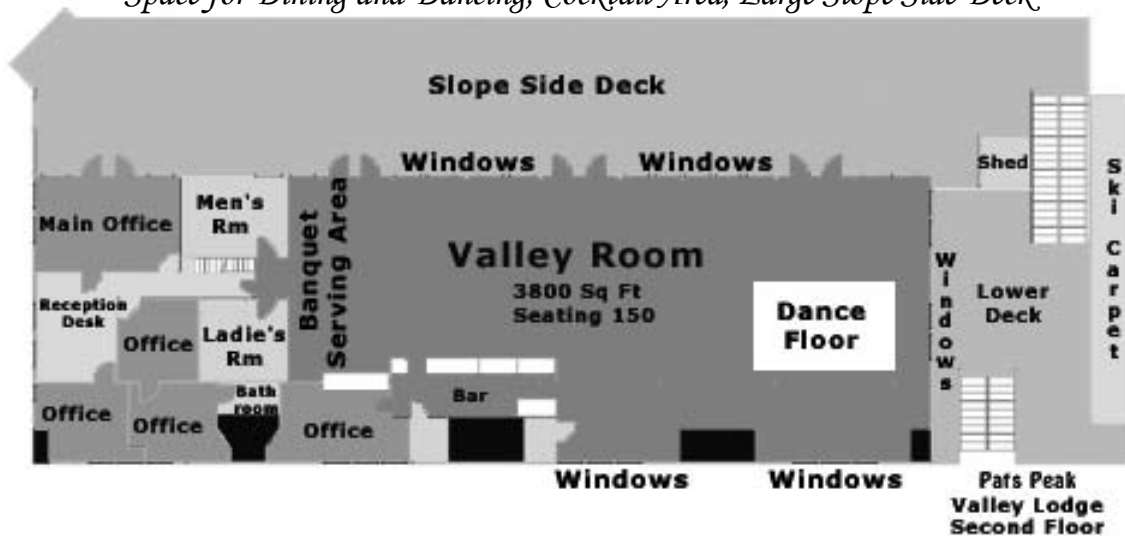

Pats Peak Banquet Center Floor Plans

Sleigh Room and Sled Pub

Located on the Third Floor of the Main Lodge

Air Conditioning, Beautiful Stone Fireplace, Space for Dining and Dancing,
Adjacent Sled Pub Lounge Area, Large Sun Deck

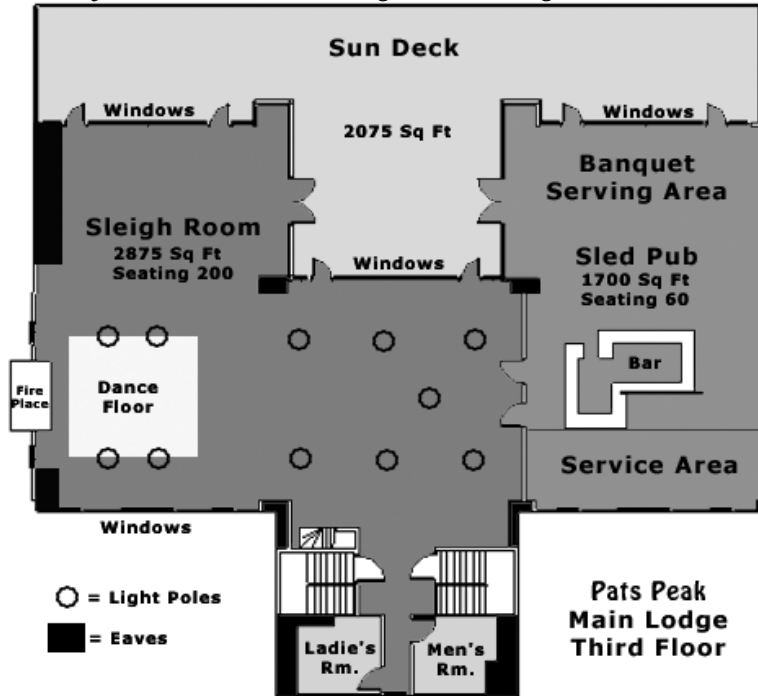

Oak Room

Located on the Second Floor of the Main Lodge

Beautiful Stone Fireplace, Indoor Wedding Ceremony Location



Corporate Meetings

*Anything We Can Do To Make Your Day Unique
And Memorable Is Our Pleasure!*



- ◆ *Personalized Service*
- ◆ *Air Conditioned Facility*
- ◆ *Rooms Can Be Arranged in Many Styles*
- ◆ *Wireless Internet Access*
- ◆ *Quiet Retreat Setting*



Thank You For Considering Pats Peak Banquet Center

Enclosed you will find helpful information on planning your meeting or workshop at Pats Peak along with our menu selections. Please remember, you are not limited to the menu selections listed. We will "cater" to your every whim! Pats Peak regularly accommodates menu requests of all types. If you have special religious or dietary needs or simply prefer another selection, Pats Peak's Banquet Staff is happy to serve you.

Choose from two air-conditioned rooms. Our rooms can be arranged in many styles with podium and microphone capabilities. Audio-visual equipment is available, please be sure to let us know your AV needs in advance. Wireless Internet Access is available in both lodges. Large wooden decks face the mountain offering spectacular views and a tranquil setting.

If you haven't done so already, please contact me to make arrangements to view our Banquet Center in person. Remember, "Personalized Service" is what makes Pats Peak a favorite meeting location. Anything our staff can do to make your day unique and memorable is our pleasure!

Sincerely,



*Jessica Gilbert
Pats Peak Banquet Center
1-888-PATS PEAK ext. 123
(603) 428-3245, ext. 123*



Meeting Guide Breakfast Selections

Prices are per person.

Continental Breakfast

\$5.95 per person

Muffins

Danishes

Bagels

Selection of Cream Cheeses and Jellies

Assorted Juices

Coffee

Tea

Breakfast Buffet

\$9.95 per person

Scrambled Eggs

French Toast

Bacon

Sausage

Home Fries

Muffins

Danishes

Assorted Juices

Coffee

Tea

18% gratuity and 9% rooms and meals tax additional on all food, beverages and room rental.

Prices subject to change.

We regret that banquet food can not be removed from the premises.

Breakfast Selections are not available for Wedding Receptions.

Pats Peak Banquet Center • Henniker, NH • (603) 428-3245 • patspeak.com



Banquet Full-Service Buffet Lunch Entree Selections

Prices are per person and include a choice of salad and dinner rolls.

If selecting (2) Lunch Entree Selections, add an additional \$4.00 per person to the higher priced lunch entree selection.

Sautéed Steak Tips with Red Wine Sauce <i>Served with Caramelized Onions, Rice Pilaf and Seasonal Vegetables.</i>	\$14.95
Grilled Salmon with Herb Butter <i>Served with Rice Pilaf and Seasonal Vegetables.</i>	\$14.95
Baked Haddock <i>Seasoned Bread Crumbs with an Herb Cream Sauce. Served with Rice Pilaf and Seasonal Vegetables.</i>	\$14.95
Lasagna <i>Select One ~ Vegetarian or Meat.</i>	\$12.95
Grilled Herbed Boneless Chicken Breast <i>Served with Rice Pilaf and Seasonal Vegetables.</i>	\$12.95
Chicken Parmesan <i>Served with Pasta and Marinara Sauce.</i>	\$12.95
Chicken & Broccoli Alfredo <i>Served with Pasta.</i>	\$12.95
Chicken Quesadilla <i>Served with Salsa, Sour Cream & Guacamole.</i>	\$10.95
Pasta Bar <i>Served with (2) selections of sauces, grilled chicken, grilled vegetables and parmesan cheese.</i>	\$10.95
Teriyaki Chicken <i>Served with rice.</i>	\$10.95
Homemade Chili <i>Served in a taco bowl with sour cream & scallions.</i>	\$9.95
8 oz. Angus Burger <i>Served with french fries.</i>	\$9.75
Soup & Salad <i>Choice of Soup and Salad.</i>	\$9.50

18% gratuity and 9% rooms and meals tax additional on all food, beverages and room rental.
Prices subject to change. We regret that banquet food cannot be removed from the premises.

We serve only Certified Angus Beef® selections.

Lunch Selections are not available for Wedding Receptions.

Pats Peak Banquet Center • Henniker, NH • (603) 428-3245 • patspeak.com



Selections to Accompany Buffet Lunch Entree

Potato / Rice

Select One

Red Roasted Potato with Garlic and Herbs
Sautéed New Potato with Fresh Dill and Onions
Baked Potato with Sour Cream and Chives
Mashed Potato
Garlic Mashed Potato
Rice Pilaf

Vegetable

Select One

Mélange - Carrots, Broccoli, Cauliflower
Glazed Carrots
Green Beans Almondine with Onion and Red Pepper
Baked Squash with Maple Syrup Sauce
Broccoli Stir Fry
Summer Squash Medley

Salad

Select One

Caesar Salad
Garden Salad
Spinach Salad
Wild Greens Salad

Pasta Sides

Add additional \$4.00 per side, per person to the entree selection price.

Tortellini Alfredo
Penne with Sausage & Peppers
Stuffed Manicotti
Pasta Primavera ~ Pesto Sauce and Vegetables
Roma ~ Roasted Garlic Cream with Red Pepper and Fresh Basil
Vegetable Lasagna
Meat Lasagna
Ravioli



Meeting Guide

Lunch Platter Selections

Prices are per person. All Sandwich Platters are served with Chips and Pickles.
Add \$1.00 per person for French Fries.

(These Lunch Platter Selections are only available for lunchtime meetings.)

Over-Stuffed Finger Sandwich Platter

\$7.95 per person

Tuna Salad

Chicken Salad

Egg Salad

Ham Salad

Assorted Wrap Platter

Select Three

\$9.95 per person

Southwestern Chicken

Seasoned Chicken, Sautéed Peppers & Onions, with Tangy Southwestern Ranch Sauce.

Roast Beef

Served with Horseradish Mustard Sauce.

Roast Turkey

Served with Lettuce, Tomato and Mayonnaise.

Smoked Ham & Swiss

Served with Honey Mustard Sauce.

Hummus, Sprouts & Red Onion

Served with Roasted Red Pepper & Spinach.

Grilled Chicken Caesar

Grilled Chicken with Classic Caesar Salad.

Italian

Salami, Ham, Tomato, Provolone Cheese & Pesto.

Gourmet Sandwich Platter

Your choice of Baguette, Croissant, Kaiser Roll or Focaccia.

Select Three

\$10.95 per person

Smoked Turkey, Smoked Bacon, Cheddar Cheese

Prosciutto, Salami, Provolone, Roasted Red Pepper, Tomato, Onion Aioli & Pesto Dressing

Grilled Chicken Roma, Sundried Tomatoes, Imported Olives, Roasted Shallot Herb Spread

Grilled Portabella Mushrooms, Zucchini, Eggplant, Roasted Garlic, Fresh Mozzarella

Seafood Salad with Herb Mayonnaise & Lettuce

French Dip with Thinly Sliced Roast Beef Au Jus

18% gratuity and 9% rooms and meals tax additional on all food, beverages and room rental.

Prices subject to change.

We regret that banquet food can not be removed from the premises.

Lunch Platter Selections are not available for Wedding Receptions

Pats Peak Banquet Center • Henniker, NH • (603) 428-3245 • patspeak.com



Meeting Guide

Lunch Soup Selections

*\$5.00 per person,
per Soup Selection.*

New England Clam Chowder

Seafood Chowder

Grilled Chicken & Corn Chowder

Cream of Broccoli

Garden Vegetable

Tomato Tortellini

Lunch Salad Selections

*\$4.50 per person,
per Salad Selection.*

Potato & Egg Salad

Mixed Baby Green Salad

Caesar Salad

Coleslaw or Broccoli Slaw

Pepper Pasta Salad

Summer Salad ~ Fresh Mozzarella, Tomato, Balsamic Vinaigrette, Over Lettuce

Spinach Salad ~ Mushroom, Egg, Tomato, Bacon, Red Onion and Red Pepper

18% gratuity and 9% rooms and meals tax additional on all food, beverages and room rental.

Prices subject to change.

We regret that banquet food can not be removed from the premises.

Lunch Selections are only available for lunchtime meetings and not available for Wedding Receptions.

Pats Peak Banquet Center • Henniker, NH • (603) 428-3245 • patspeak.com



Meeting Guide

Lunch Entree Salad Creations

(These Lunch Entree Salad Creations are only available for lunchtime meetings.)

Create Your Own Salad!

\$10.95 per person

Ingredients are served buffet style for each guest to "create their own."

Served with rolls & salad dressing.

Caesar

Fresh Chopped Romaine Lettuce

Parmesan Cheese

Croutons

Grilled Chicken

Grilled Steak Tips

Grilled Eggplant, Summer Squash, Zucchini, Roasted Red Pepper,

Portabella Mushrooms, Black Olives & Anchovies

All American

Fresh Wild Greens Salad

Turkey

Ham

Cheddar Cheese

Crumbled Bacon

Hard Boiled Egg

Croutons

Cucumber, Tomato, Mushroom, Onion, Pepper & Avocado

Oriental

Oriental Salad Blend of Green Leaf Lettuce and Bok Choy

Sauteed Shrimp

Sauteed Teriyaki Chicken

Scallions, Water Chestnuts, Bean Sprouts, Chow Mein Noodles, Almonds,

Snow peas, Mandarin Orange Slices & Red Peppers

*18% gratuity and 9% rooms and meals tax additional on all food, beverages and room rental.
Prices subject to change. We regret that banquet food cannot be removed from the premises.*

We serve only Certified Angus Beef® selections.

Lunch Entree Salad Creations are not available for Wedding Receptions.

Pats Peak Banquet Center • Henniker, NH • (603) 428-3245 • patspeak.com



Meeting Guide Hors d'oeuvres Selections

Prices are per person.

Garden Crudite <i>Fresh Raw Vegetable Display with Seasoned Dips.</i>	\$3.00
Gourmet Fromage Display <i>Muenster, Cheddar, Swiss, Pepper Jack, Garlic Herb Spread, Smoked Gouda, Dill Havarti, Pepperoni, Salami, Fresh Fruit including Grapes, Strawberries & Melon with Assorted Crackers.</i>	\$4.00
Flat Bread Alfredo Pizza <i>Alfredo Sauce, Fresh Tomato & Fresh Basil.</i>	\$3.00
Meatballs <i>Select One ~ Italian, Swedish, BBQ, Sweet and Sour</i> <i>Select Two ~ Italian, Swedish, BBQ, Sweet and Sour</i>	\$3.00 \$3.25
Stuffed Mushroom Caps <i>Select One ~ Crab Almond, Spinach Feta, Mild Italian, Spicy Cajun</i> <i>Select Two ~ Crab Almond, Spinach Feta, Mild Italian, Spicy Cajun</i>	\$3.00 \$3.25
Baked Brie <i>Select One ~ Raspberry Almond En Croute, Hazelnut Crusted served with fresh pears</i>	\$4.00
Mediterranean Display <i>Warm Artichoke and Spinach Dip, Hummus and Spanakopita accompanied by crackers and bread.</i>	\$4.00
Chicken Satay <i>Marinated Chicken Grilled and Served with a peanut sauce.</i>	\$4.00
Mini Crab Cakes <i>Homemade mini Crab Cakes served with a horseradish mayonaise sauce.</i>	\$4.50
Teriyaki Steak Skewers <i>Marinated Steak Skewers served with a teriyaki dipping sauce.</i>	\$4.50
Shrimp Cocktail <i>Large Shrimp served cool and crisp with cocktail sauce.</i>	\$5.00
Scallops Wrapped in Bacon <i>Fresh Scallops wrapped in bacon and baked. Brushed with a maple syrup glaze.</i>	\$5.00

**Most Hors d'oeuvres can be passed upon request.*

*18% gratuity and 9% rooms and meals tax additional on all food, beverages and room rental.
Prices subject to change. We regret that banquet food cannot be removed from the premises.*

We serve only Certified Angus Beef® selections.



Pats Peak Banquet Center • Henniker, NH • (603) 428-3245 • patspeak.com

Dessert Selections

*Prices are per person,
per Dessert Selection.*

<i>Chocolate Dipped Strawberries</i>	<i>\$4.00</i>
<i>Vanilla Cream Puffs Laced with Chocolate</i>	<i>\$4.00</i>
<i>Fruit Filled Crepes</i>	<i>\$4.00</i>
<i>Almond Joy Tart</i>	<i>\$4.00</i>
<i>Brownie Sundae</i>	<i>\$4.00</i>
<i>Assorted Cheesecake</i>	<i>\$4.00</i>
<i>Tiramisu</i>	<i>\$3.75</i>
<i>Strawberry Shortcake</i>	<i>\$3.50</i>
<i>Brownie</i>	<i>\$3.50</i>
<i>Carrot Cake</i>	<i>\$3.50</i>
<i>Fresh Fruit Platter</i>	<i>\$3.50</i>
<i>Assorted Cookie Tray</i>	<i>\$3.00</i>
<i>Apple Crisp</i>	<i>\$3.00</i>
<i>Apple Pie</i>	<i>\$3.00</i>

Chocolate Fountains available - Please inquire if interested.

18% gratuity and 9% rooms and meals tax additional on all food, beverages and room rental.

Prices subject to change.

We regret that banquet food can not be removed from the premises.



Pats Peak Banquet Center • Henniker, NH • (603) 428-3245 • patspeak.com

Beverage Selections

We serve a full range of spirits, wines and beer.

*You may arrange for a full open bar, limited open bar, or a cash bar,
whatever meets your needs.*

Liquor Prices

<i>Domestic & Imported Draft Beer</i>	<i>\$4.25 to \$7.25</i>
<i>Bottle Beer (Valley Room Only)</i>	<i>\$4.75 to \$6.25</i>
<i>House Wine</i>	<i>\$5.00</i>
<i>Soda</i>	<i>\$1.75</i>
<i>Juice</i>	<i>\$1.75</i>
<i>Mixed Drinks</i>	<i>\$5.00 to \$7.00</i>

Champagne Toasts

<i>Domestic Champagne</i>	<i>\$3.00 per person</i>
<i>Non-Alcoholic Sparkling Cider or Grape</i>	<i>\$3.00 per person</i>
<i>Imported Champagne</i>	<i>\$4.00 per person</i>

Punch Bowls

<i>Spirited Bowl (serves 30)</i>	<i>\$85.00</i>
<i>Non-Spirited Bowl (serves 30)</i>	<i>\$50.00</i>

18% gratuity and 9% rooms and meals tax additional on all food, beverages and room rental.

Prices subject to change.

Beverage Policy ~ Pats Peak's managers, bartenders and servers are trained in responsible beverage service and if necessary will deny service to anyone that, in their opinion, appears to have consumed more alcohol than is considered safe and responsible. Under no circumstances will anyone under 21 years old be served. In accordance with NH State Law, no alcohol is allowed to be brought onto or leave the premises by guests.



Pats Peak Banquet Center • Henniker, NH • (603) 428-3245 • patspeak.com

Midweek Corporate Meetings/Workshops

For midweek corporate meetings/workshops, the Rental Fee is based on an (8) eight-hour time period.
Fees Subject To Change.

Rental Fee includes Linens, Set-Up, Clean-Up, Coffee and Tea Station,
Full China Setting including Water Goblet, Luncheon Plate, Salad Plate & Silverware.

<u>Room</u>	<u>Rental Fee with Food Purchase</u>	<u>Rental Fee with No Food Purchase</u>
Sleigh Room (includes Sled Pub)	\$200	\$500
Valley Room	\$200	\$500

*Greater Concord Chamber of Commerce Members and Henniker Chamber of Commerce Members receive a discounted rate, please inquire if you are a member.

Audio Visual Equipment

Limited Audio Visual available onsite.

Please let us know what you need for your event and we will do our best to provide it for you.

Some items may require an additional rental fee.

Screen

Podium

Microphone

Television

DVD

VCR

Terms and Conditions

Subject To Change

- A \$500 Non-Refundable/Non-Transferable Deposit and Signed Contract will secure the date of your choice.
- We require 50% payment of your Estimated Bill (1) One Month prior to your event. Cancellation within 30 days or less of scheduled event will result in forfeiture of 50% of total balance of estimated invoice.
- The Final Menu Selections, Confirmed Numbers and Final Balance due (2) Two Weeks prior to your event. Cancellation within 14 days or less of scheduled event will result in forfeiture of 100% of total balance of final invoice.
- MasterCard, Visa and American Express credit cards are welcomed.
- 18% gratuity and 9% rooms and meals tax additional on all food, beverages, and room rental.



Directions To Pats Peak Banquet Center

686 Flanders Road, Henniker, NH 03242

*“The Only Henniker On Earth”
Conveniently located in Southern NH off I-89*

From Manchester, NH

40 Minutes

Take I-93 North to Concord, NH. Take I-89 North. Take Exit 5 (a left hand exit). Follow Route 202/9 West. Take the Henniker Exit (Route 114). Follow Route 114 South. Go straight through the center of town for approximately 2 miles and look for the Pats Peak sign on your right. Take the right and follow the road to the Pats Peak entrance.

From Boston, MA

1 1/2 Hours

Take I-93 North to Concord, NH. Take I-89 North. Take Exit 5 (a left hand exit). Follow Route 202/9 West. Take the Henniker Exit (Route 114). Follow Route 114 South. Go straight through the center of town for approximately 2 miles and look for the Pats Peak sign on your right. Take the right and follow the road to the Pats Peak entrance.

From Burlington, VT

2 Hours

Take I-89 South to Exit 5 (Route 202/9 West). Proceed on Route 202/9 West to the Henniker Exit (Route 114). Follow Route 114 South. Go straight through the center of town for approximately 2 miles and look for Pats Peak on your right. Take the right and follow the road to the Pats Peak entrance.

From Brattleboro, VT

1 1/4 Hours

Take Route 9 East to Henniker. Take the Henniker Exit (Route 114). Follow Route 114 South. Go straight through the center of town for approximately 2 miles and look for the Pats Peak sign on your right. Take the right and follow the road to the Pats Peak entrance.

From Portsmouth, NH

1 1/4 Hours

Take Route 4 West to Concord, NH. Merge onto I-393 West/US-202 West/US-4 West toward I-93. Take I-93 South toward I-89. Take I-89 North. Take Exit 5 (a left hand exit). Follow Route 202/9 West. Take the Henniker Exit (Route 114). Follow Route 114 South. Go straight through the center of town for approximately 2 miles and look for the Pats Peak sign on your right. Take the right and follow the road to the Pats Peak entrance.



Pats Peak Banquet Center Floor Plans

Pats Peak Base Area

Main Lodge and Valley Lodge

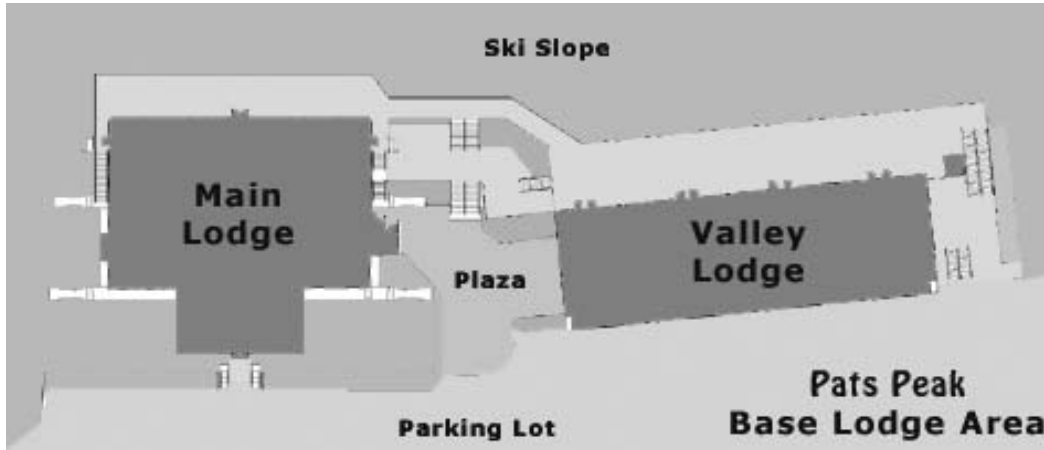

The Valley Room

Located in the Valley Lodge

*Air Conditioning, Beautiful Large Windows,
Space for Dining and Dancing, Cocktail Area, Large Slope Side Deck*

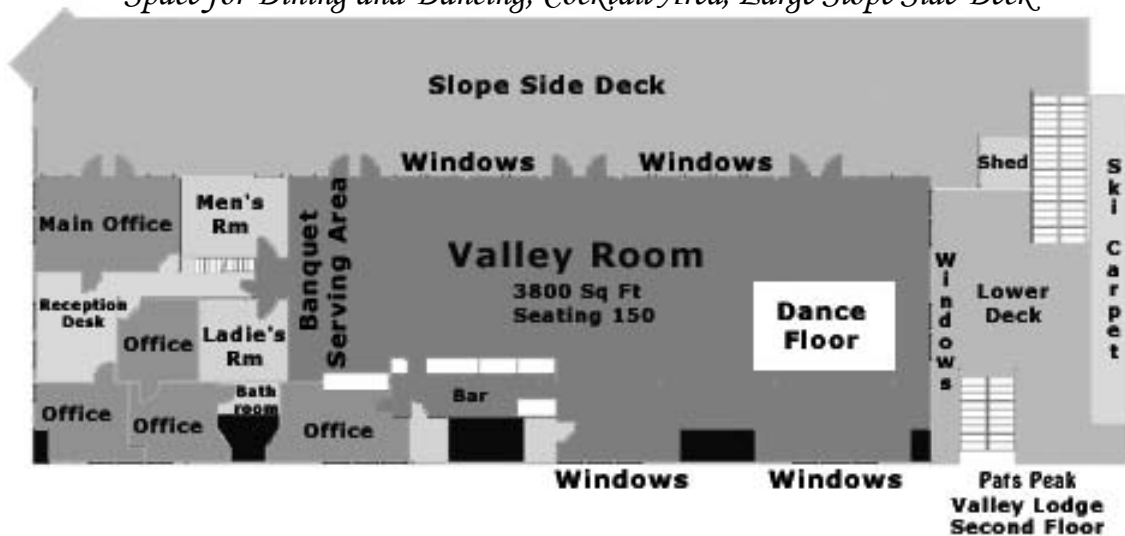

Pats Peak Banquet Center Floor Plans

Sleigh Room and Sled Pub

Located on the Third Floor of the Main Lodge

Air Conditioning, Beautiful Stone Fireplace, Space for Dining and Dancing,
Adjacent Sled Pub Lounge Area, Large Sun Deck

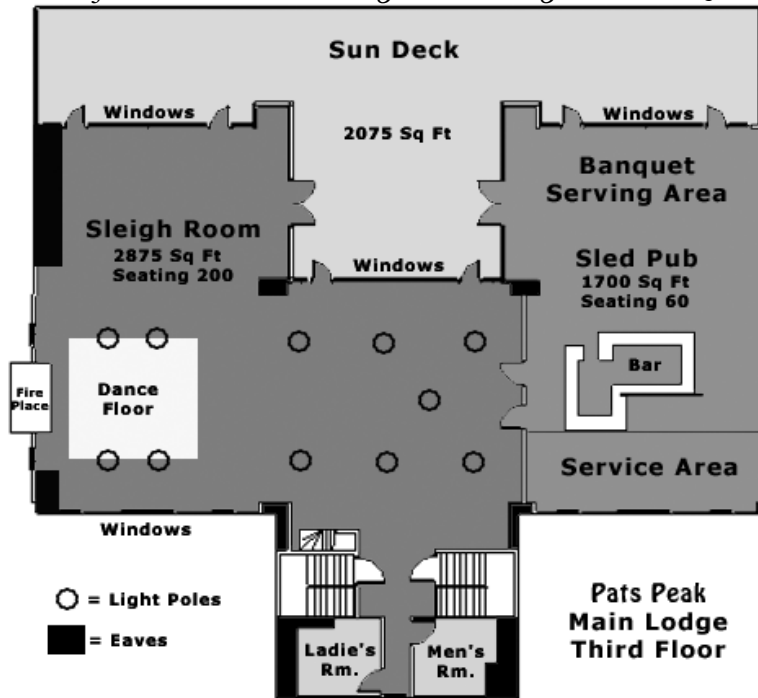

Oak Room

Located on the Second Floor of the Main Lodge

Beautiful Stone Fireplace, Indoor Wedding Ceremony Location

